



FALLPROTEC

Height Safety Products

01

Height Safety Systems

A. Horizontal and Inclined Fall Arrest

EN795:2012 Type C / Type D / Type A
CEN/TS 16415:2013

SecuRope Cable Lifeline	
On ground	6
Overhead	8
Case Study: Installation in Industrial Halls	10
SecuRope Cable Lifeline Inclined	12
SecuRope Fixing Assembly	
On post	14
On cold deck	16
On standing seam roof	18
On hot deck	20
On DiaSafe post	22
Case Study: Installation in Saint-Gobain Factory	24
SecuRail Lifeline Horizontal and Inclined	26
SecuRail 2016 Lifeline Horizontal	28
Case Study: Installation in Rive Gauche Mall	30
SafeAccess Rail Fall Arrest	32

B. Vertical Fall Arrest

EN353-2:2014

SecuRope Cable Lifeline	34
SecuRail Lifeline	36
SafeLadder Lifeline	38

C. Anchor Points

EN795:2012 Type A / CEN/TS 16415:2013	42
---------------------------------------	----

D. Personal Protective Equipment

EN362:2005 / EN358:2003 / EN361:2003 EN355:2003 / EN365:2005 / EN813:2009 EN354:2011 / EN360:2003	
Harnesses and Lanyards	46
Retractable Blocks	48
Case Study: Installation in Kapsarc Project	50

02

Safe Access Equipment

E. Works In Suspension

EN1808:2015 / EN60204-1
Directive 2006/42/EC

SafeAccess Rail	52
Case Study: Installation in New Antofagasta Hospital	54
SafeAccess C Rail	56
SafeAccess Climbing Rail	58
RopeClimber Lifting Equipment	60
Case Study: Installation in Tianjin International Convention Center	62

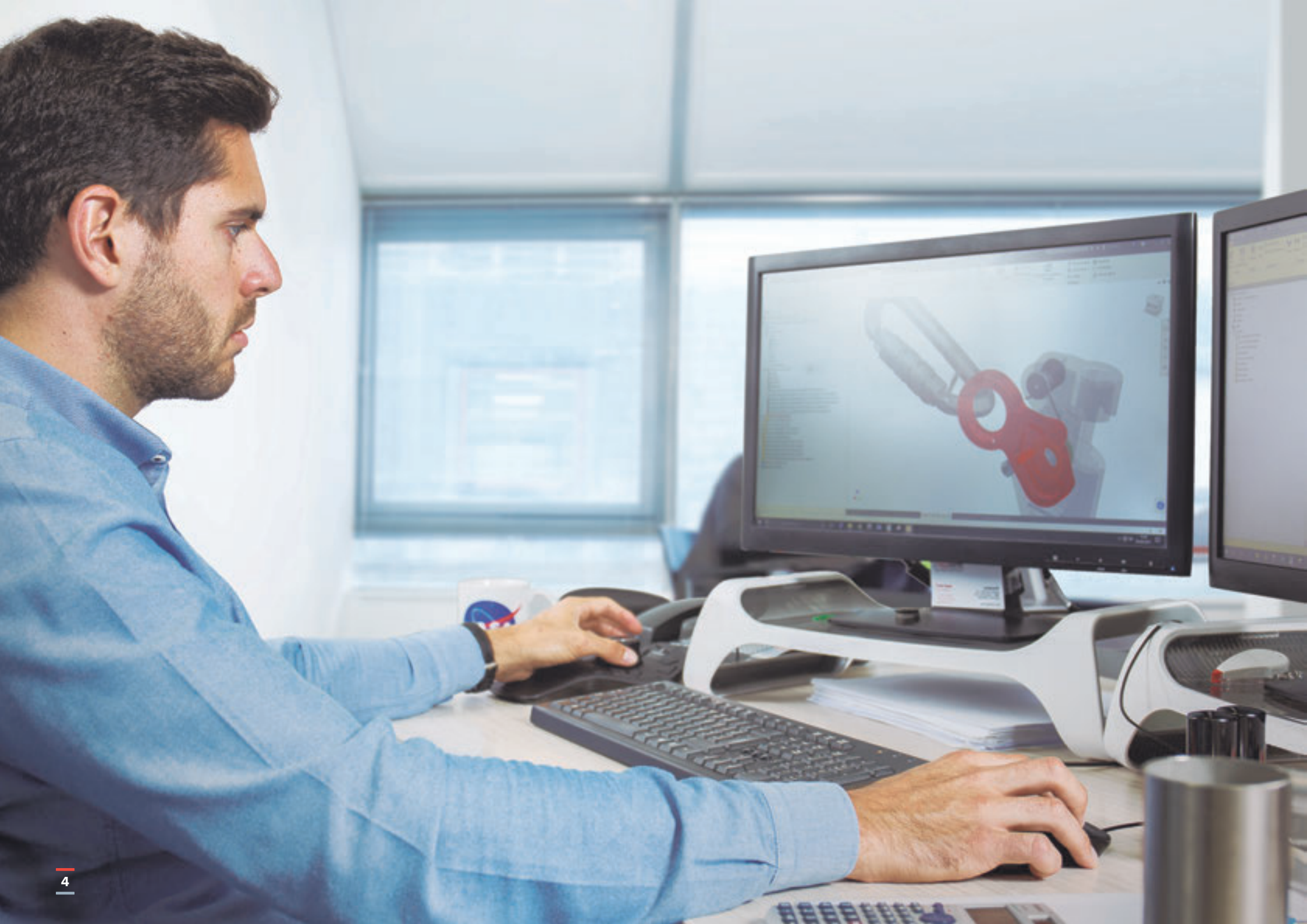

OUR ACHIEVEMENT IS WORKER'S SAFETY

Fallprotec has innovation in its DNA and continuously invests into product development which enables the company to market a comprehensive range, of fall arrest and height safety systems.

Fallprotec is also a one-stop shop providing services such as industrial site audits, engineering and training in its own facilities. The professional staff provides the best support to its clients, distributors and installers on a daily basis as well as guide the final customer from the first-scratch concepts up to the final installation.

Thanks to the network of branch offices, liaison offices, distributors and certified installers in more than 48 countries, Fallprotec is recognised as a full blue-chip provider of safety and access equipment with worldwide recognition, i.e.:

- By major industrial entities who trusted its solutions for the safety of their employees.
- By renown architects or major construction companies where its activity consists in following large-scaled and complex projects from the design phase to the installation with bespoke solutions.

01

Height Safety Systems
Horizontal and Inclined Fall Arrest

SecuRope®

On ground

- For 4 users
- Freehand system
- Undeformable
- Energy absorbing on intermediate anchors
- Components available in stainless steel or in copper alloy for potentially explosive environments
- Possibility of custom-made solutions with the Fallprotec's engineering department

EN795:2012 Type C
CEN/TS 16415:2013





Horizontal SecuRope lifeline directly on concrete

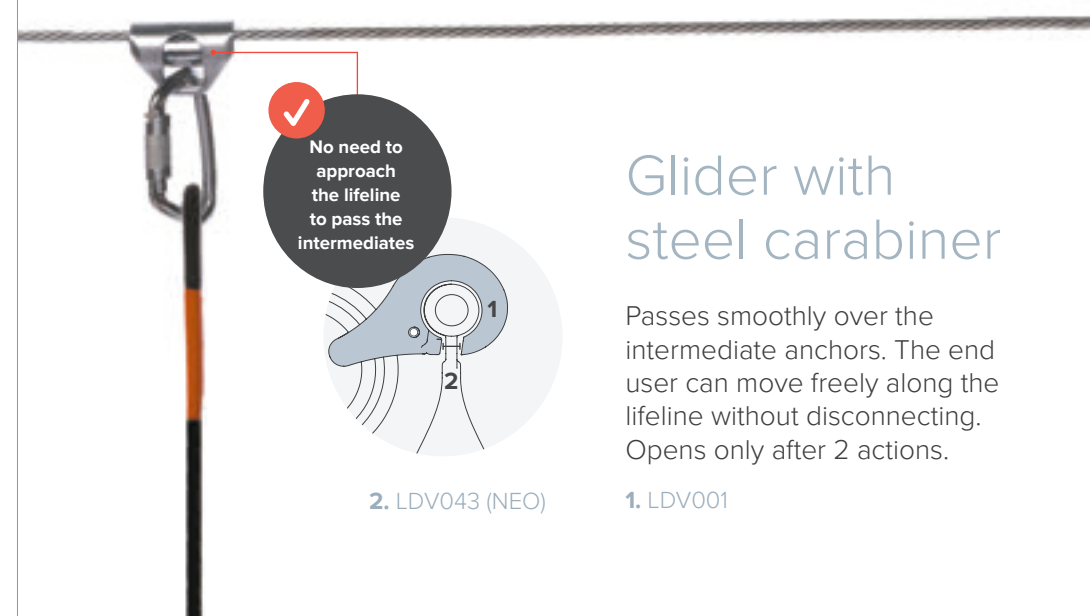

Intermediate anchors for horizontal lifelines



The NEO anchor and the LDV004 are roof protecting thanks to their integrated shock absorbing system. Both are reusable anchors after stopping a fall.

LDV043 (NEO)

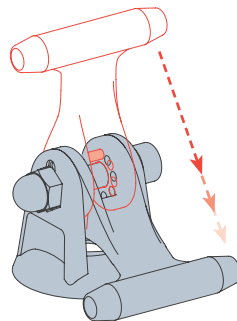

✓ Energy absorption by shear pin breaking



✓ Brake mechanism

LDV004



The EVO anchor, a competitive solution, has been specifically designed for concrete grounds and rigid structures.

LDV083 (EVO)

	LDV043 (NEO)	LDV004	LDV083 (EVO)
Energy absorbing	•	•	
Undeformable	•	•	•
Stainless steel components	•	•	•
Suitable for rigid structures	•	•	•
Available in copper alloy for ATEX environments	•		

SecuRope® Overhead

- For 4 users
- Undeformable
- Can be used with retractable fall arresters
- Often used in the industry for works above machines, with a distance between the lifeline and the walkway up to 7m
- Can be installed in corrosive environments
- Copper-alloy elements available for ATEX environments

EN795:2012 Type C
CEN/TS 16415:2013



→ SecuRope overhead safety line.

Most used configuration for industrial halls as the lifeline above the user reduces the fall distance.



NEO SecuRope Lifeline between two walls and NEO SecuRope Lifeline on wall configuration

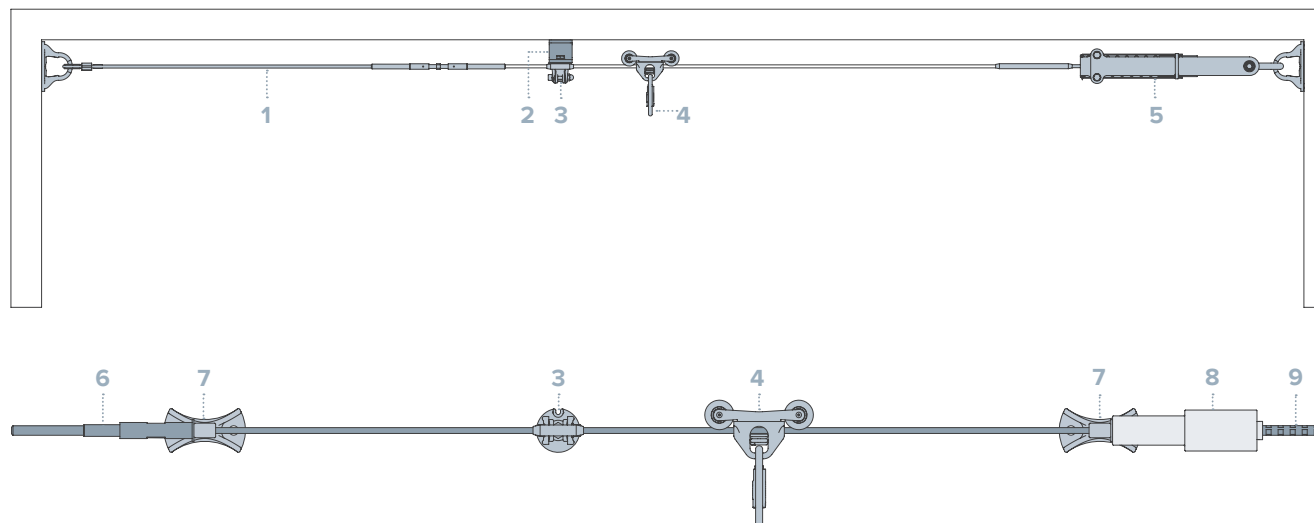

1. LDV054
2. LDV134
3. LDV043 (NEO)
4. LDV133
5. LDV139
6. LDV137
7. LDV002
8. LDV032
9. LDV008

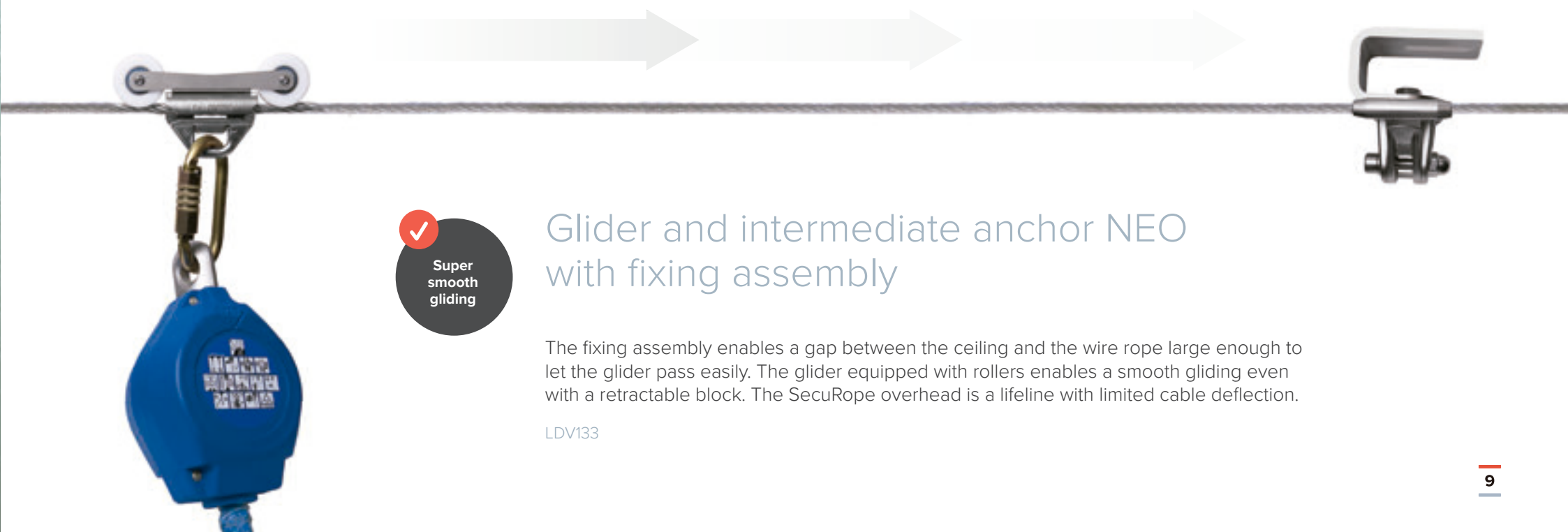

Super
smooth
gliding

Glider and intermediate anchor NEO with fixing assembly

The fixing assembly enables a gap between the ceiling and the wire rope large enough to let the glider pass easily. The glider equipped with rollers enables a smooth gliding even with a retractable block. The SecuRope overhead is a lifeline with limited cable deflection.

LDV133



Wallerich steel factory

Case Study

- Bespoke posts for overhead and wall lifelines
- SecuRope lifeline



📍 Luxembourg



The Brief

In order to secure the Wallerich assembly lines, Fallprotec's engineering department adapted the SecuRope system to cope with the particular requirements of the factory.

- 700m of SecuRope lifeline.
- 10 types of bespoke fixation assemblies, adapted to various beam sizes and distances between beams and walkways.
- Undeformable lifeline.
- Surpassable intermediate anchors.



Bespoke fixing brackets and clamps



CAD modelization of bespoke fixing brackets using clamps to maintain a steady distance between lifelines and walkways.



Stress test illustration



Stress calculation for
fixing assembly on beam.

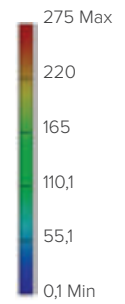

Units: MPa



01

Height Safety Systems
Horizontal and Inclined Fall Arrest

SecuRope®

Inclined

- Intuitive use
- Can be installed on slopes from 30° to 90°
- Stainless steel components
- Undeformable
- Freehand system
- For 4 users
- Energy absorbing on intermediate anchors
- Suitable for ATEX environments

EN795:2012 Type C
CEN/TS 16415:2013





- | | |
|-----------------|-----------|
| 1. LDV043 (NEO) | 3. LDV075 |
| 2. LDV107 | 4. LDV032 |

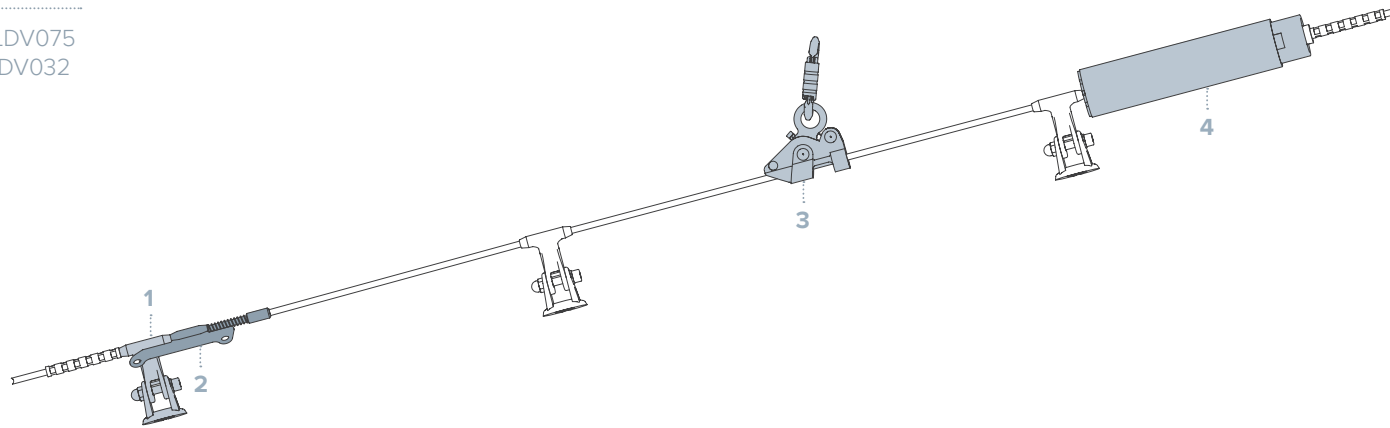

Fall arrest Zip! on inclined line 30°- 90°

Smooth gliding
through the anchors.

LDV075



Brake
mechanism

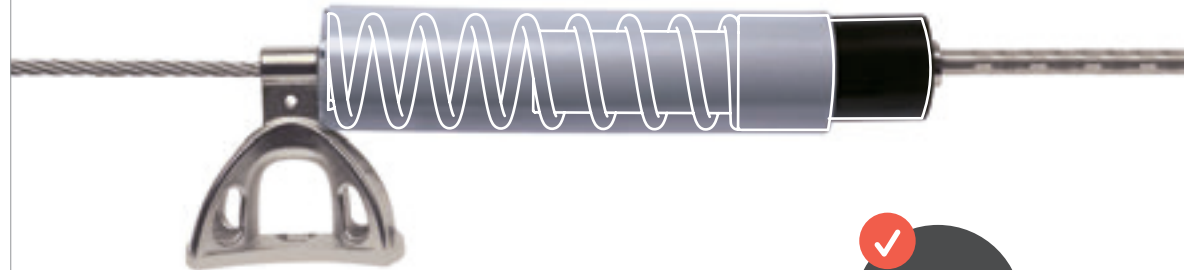

Energy
absorbing
system

End anchor with energy absorber
and constant tension mechanism
for fragile structures

LDV002 / LDV032

01

Height Safety Systems
Horizontal and Inclined Fall Arrest

SecuRope®

On post

- Undeformable
- Supplied with standard roofing systems that ensure the integrity of the waterproofing membrane
- Available in stainless steel or galvanised steel, the posts are 50 to 75 cm high depending on the thickness of the isolation

EN795:2012 Type C
CEN/TS 16415:2013



→ For rigid structures such as concrete or steel beams, the undeformable Fallprotec post is a safe choice.

Combined with the SecuRope EVO lifeline, the end user has an excellent freedom of movement and can safely reach any point of the structure.

The user stays connected while moving along the lifeline and passing the intermediate anchors.



SecuRope EVO lifeline on posts

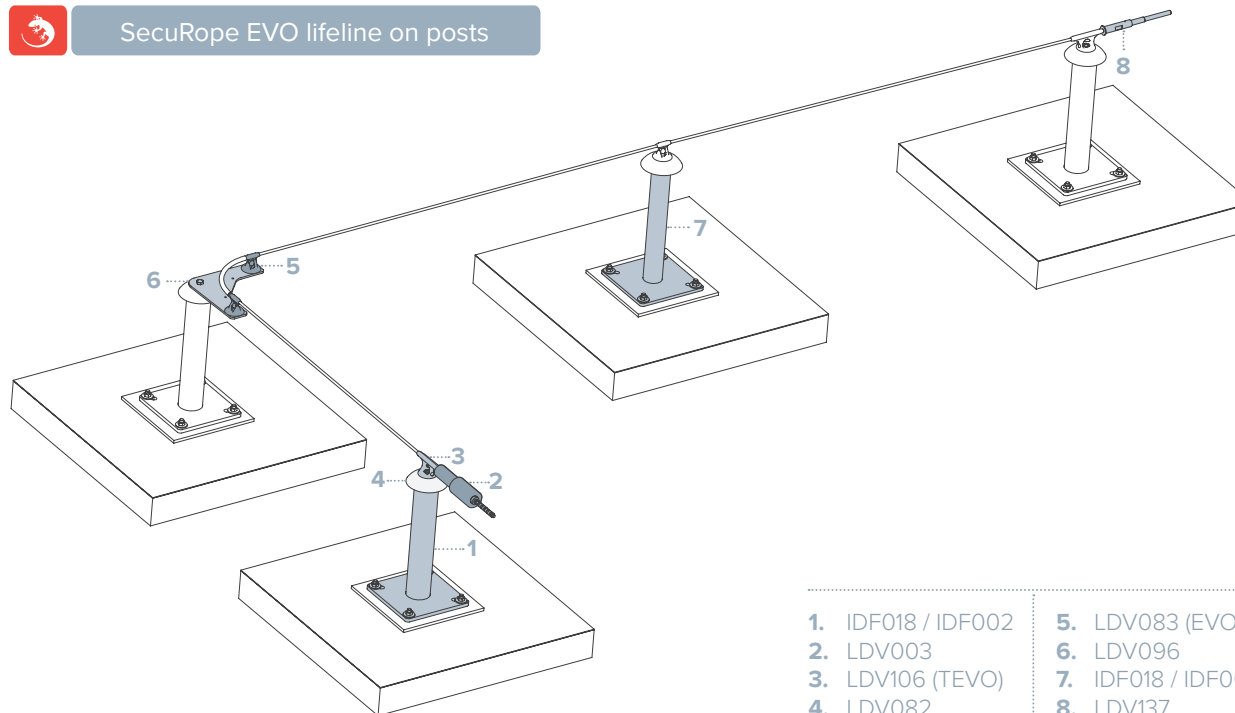

- | | |
|--------------------|--------------------|
| 1. IDF018 / IDF002 | 5. LDV083 (EVO) |
| 2. LDV003 | 6. LDV096 |
| 3. LDV106 (TEVO) | 7. IDF018 / IDF001 |
| 4. LDV082 | 8. LDV137 |

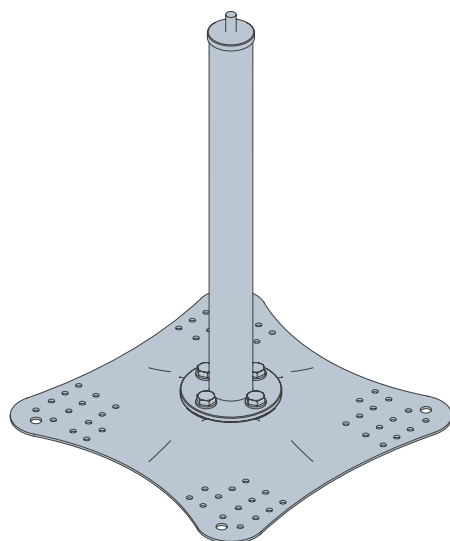

UniPost

Deformable post that absorbs the energy in case of a fall. Specially designed for roof installers, it is either installed directly on the trapezoidal metal sheet or on the isolation.

01

Height Safety Systems
Horizontal and Inclined Fall Arrest

SecuRope® On cold deck

- For 4 users
- Energy absorbing
- Absorbs dilatation and contraction of roof sheets
- Supplied with EPDM roofing system that ensures integrity of waterproofing membrane

EN795:2012 Type C
CEN/TS 16415:2013

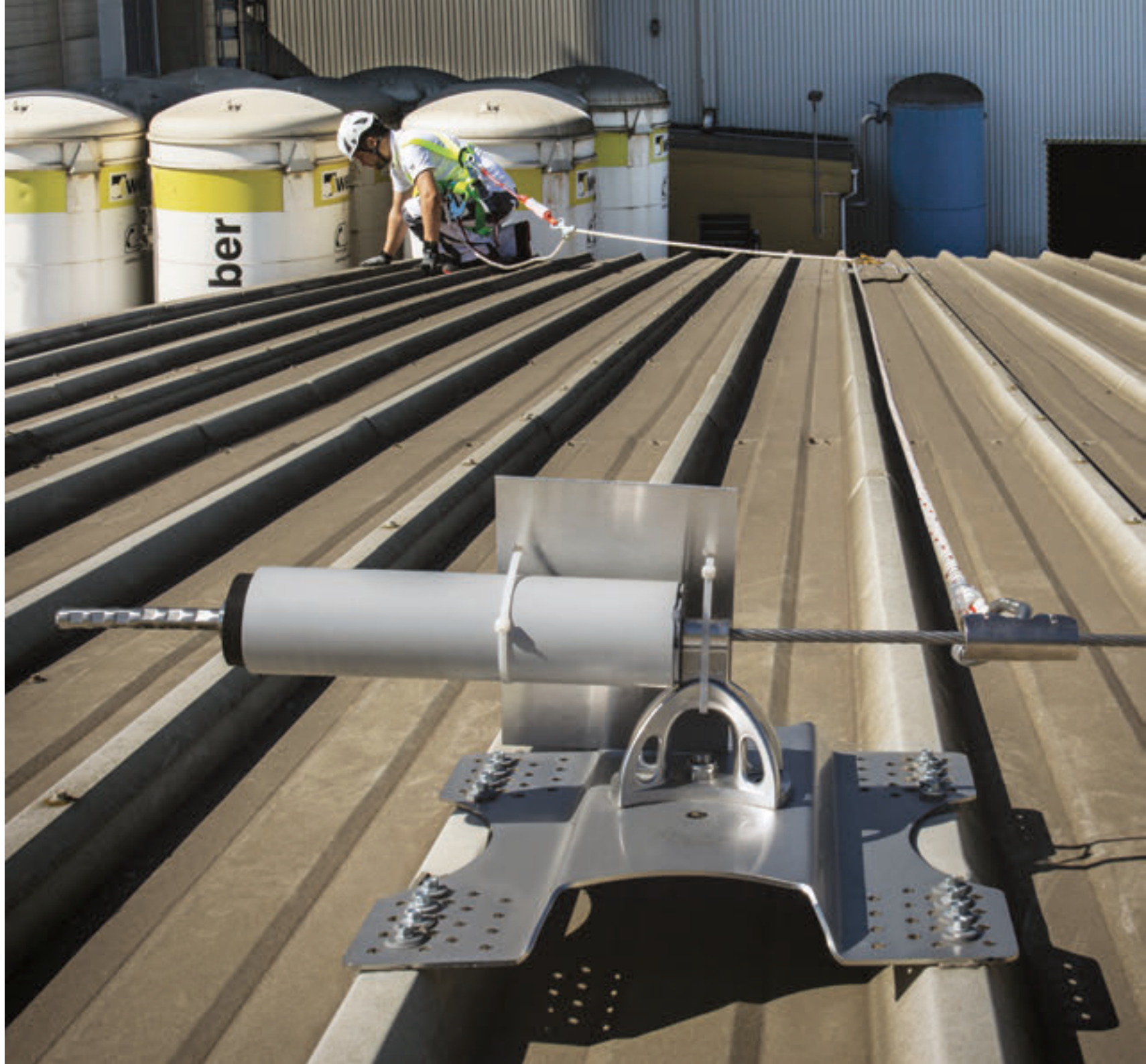

→ The fixing bracket for cold deck roofs has a unique design that distributes the load evenly.

Combined with the energy absorbing mechanism of the SecuRope NEO lifeline, it is the best system for fragile roofs.

Supplied with self drilling screws specially designed for their high pull out strength.

Ideal for the maintenance and repair of any industrial facility. Safe access to solar panels, ventilation outlets, roof skylights and gutters.



SecuRope NEO on cold deck

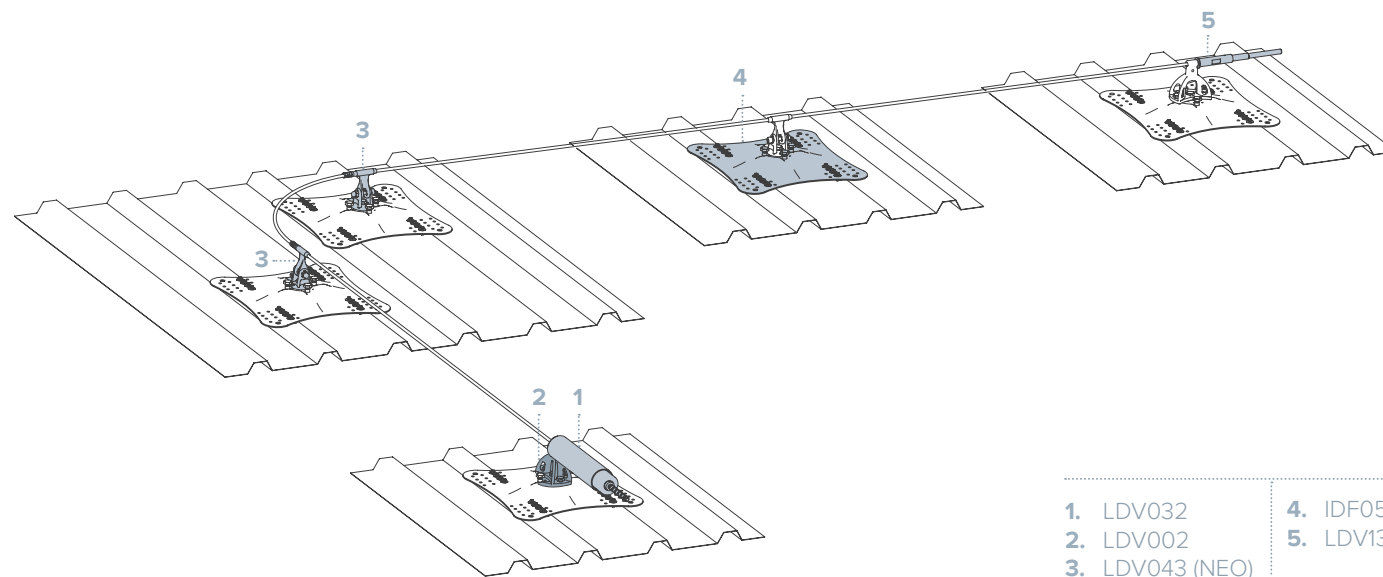

- | | |
|-----------------|-----------|
| 1. LDV032 | 4. IDF053 |
| 2. LDV002 | 5. LDV137 |
| 3. LDV043 (NEO) | |



Fixing detail

The bracket is fixed on the corrugated metal sheet with self-drilling screws. The sealing tape in EPDM ensures the watertightness.

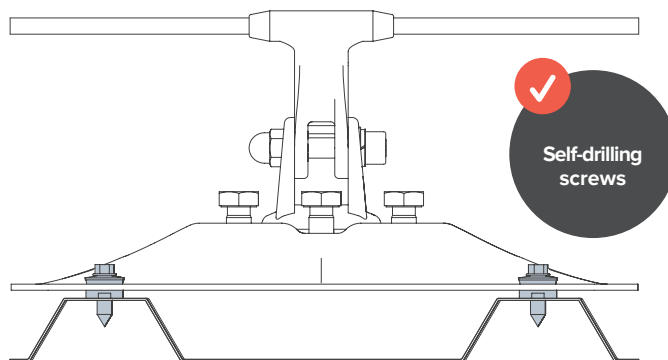

NEO Anchor on fixing assembly

The bracket ensures a homogeneous distribution of the pull-out force on the cold deck roof.

LDV043 (NEO) / IDF053



01

Height Safety Systems
Horizontal and Inclined Fall Arrest

SecuRope® On standing seam roof

- For 4 users
- Energy and dilatation absorbing
- No drilling needed
- Aluminium and stainless steel components

EN795:2012 Type C
CEN/TS16415:2013



→ The fixing bracket for standing seam roof is clamped on the seam and doesn't require any perforation.

A wide range of clamps is available which fit perfectly to the various standing seam roof types. The clamps combine high pull out and shear strength.

Combined with the SecuRope NEO lifeline, the system completely absorbs the dilatation and contraction of the metallic standing seam roof.

Easy to install on new constructions or existing buildings.



SecuRope NEO on standing seam roof

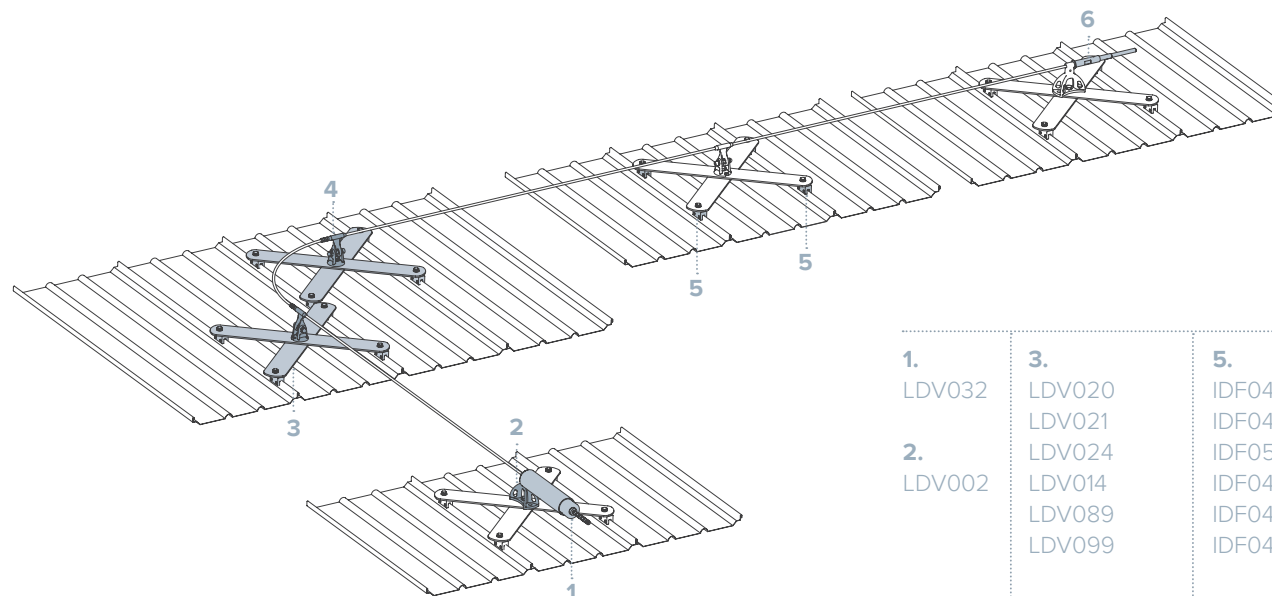

1. LDV032	3. LDV020 LDV021 LDV024 LDV014 LDV089 LDV099	5. IDF042 IDF045 IDF054 IDF044 IDF043 IDF041
2. LDV002	4. LDV043 (NEO)	6. LDV137



Fixing detail

The clamp can be installed anywhere along the seam.

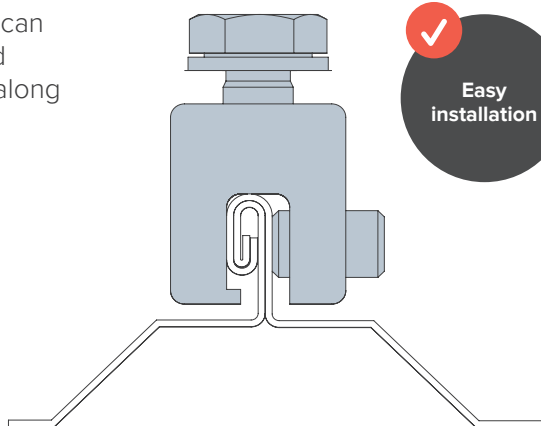

NEO Anchor on fixing assembly

The cross ensures a proper fixing on the standing seam and load distribution.

LDV043 (NEO)
LDV014



01

Height Safety Systems
Horizontal and Inclined Fall Arrest

SecuRope®

On hot deck

- For 4 users
- Undeformable
- Energy absorbing

EN795:2012 Type C
CEN/TS 16415:2013



→ The Multipost and SpotAnchor are designed for hot deck roofs.

High resistance toggle bolts enable the fixation on corrugated metal sheets, wooden panels or precast concrete.

Only the toggle bolts passes through the isolation, eventually the thermal bridges occurring are minimized. The roofing collar, in bitumen or PVC-P, is prefitted in the factory to guarantee the waterproofness.

Easier to retrofit on existing buildings.



SecuRope NEO on hot deck

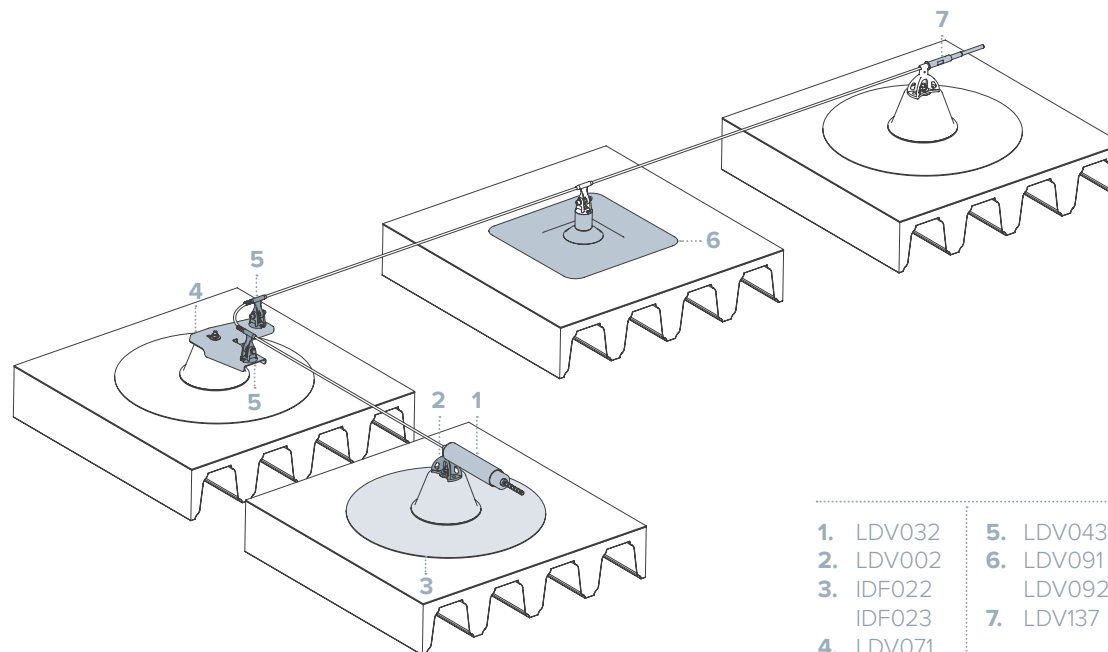

- | | |
|-----------|-----------|
| 1. LDV032 | 5. LDV043 |
| 2. LDV002 | 6. LDV091 |
| 3. IDF022 | LDV092 |
| IDF023 | 7. LDV137 |
| 4. LDV071 | |



Fixing detail of SpotAnchor

The SpotAnchor is fixed by a reinforced toggle bolt. This allows a distribution of forces on a large surface.

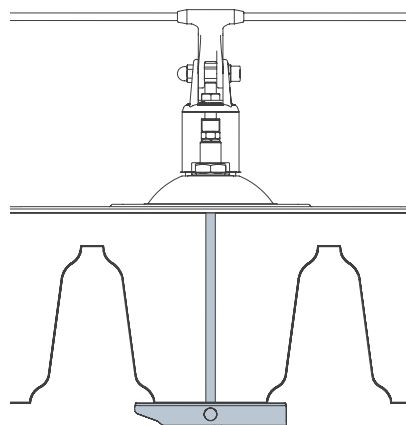

NEO Anchor on fixing assembly

For modern constructions with wooden panels, the SecuRope lifeline is installed on MultiPost.

LDV043 (NEO) / IDF022



01

Height Safety Systems
Horizontal and Inclined Fall Arrest

SecuRope® On DiaSafe post

- Preserves the roof's isolating properties
- Stainless steel anchor point
- No perforation of roofing membrane
- Possibility of custom-made solutions with the Fallprotec's engineering department

EN795:2012 Type C & Type A
CEN/TS 16415:2013



→ The Diasafe post is either used as anchor point for one or two persons or as support for the lifeline. It can be used on horizontal roofs up to a slope of 5°. An energy absorbing device is integrated.

The stability is ensured by a ballast weight, gravels or substrate. The installation is done without penetration of the roofing membrane. Thermal bridges and the risk of water infiltration are eliminated. In case of a fall, the post will deform permanently, protecting the under layers.



Horizontal SecuRope lifeline on DiaSafe post

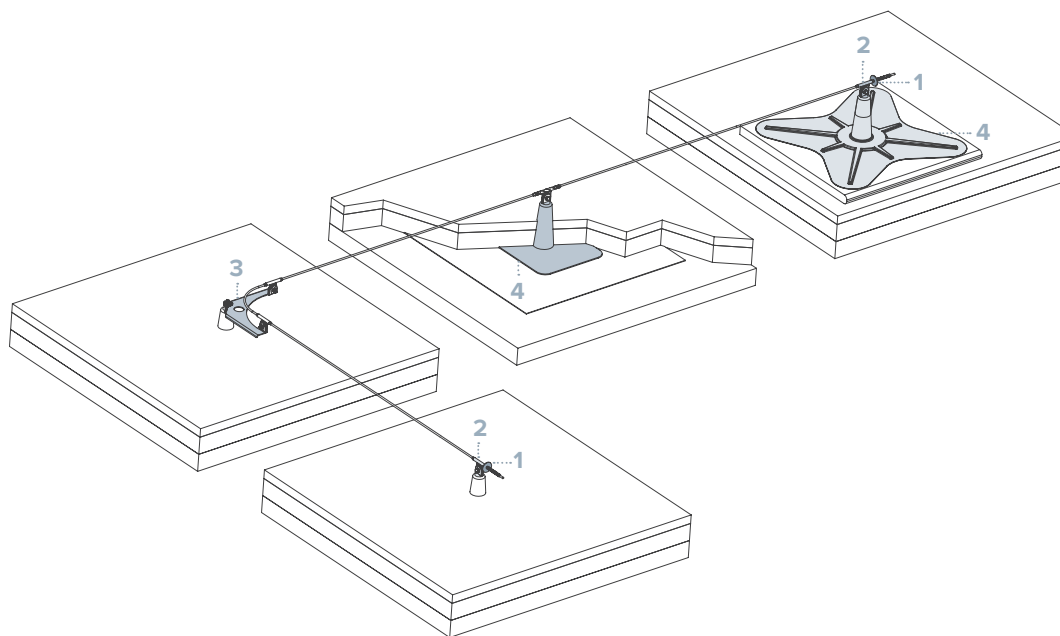

Green roof compliance

1. LDV008
2. LDV100
3. IDF010
4. IDF008



DiaSafe anchor point

The metallic eye allows the attachment of one or two people or the attachment of the SecuRope anchor.

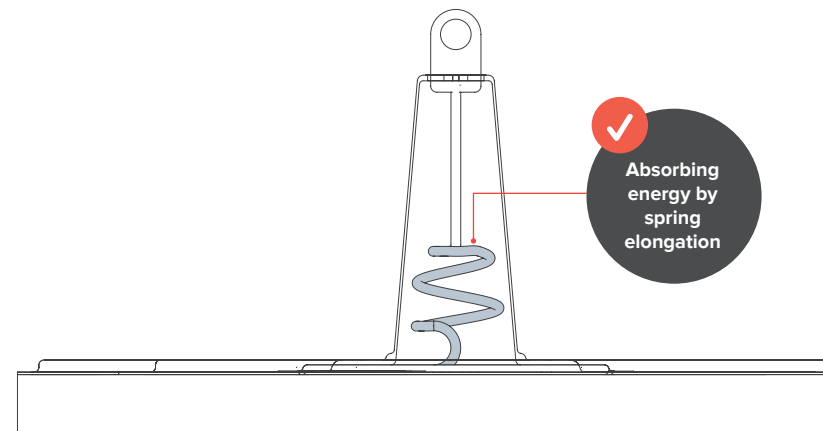

Absorbing energy by spring elongation



Saint-Gobain Factory

Case Study

- Securing industrial roof and access ladders
- 4 different integrated solutions: SafeLadder, SecuRope on hot deck, SecuRope and anchor point on cold deck



Poland

The Brief

A wide range of solutions and fixation assemblies are set up on the production site of Saint-Gobain in Poland.

As specialist, Fallprotec offers one stop shop services as well as key in hand solutions to its industrial customers.





The Results

- 12m of SafeLadder with exit to access the roof.
- 200m of SecuRope lifeline on cold deck roof.
- 150m of SecuRope lifeline on hot deck roof.
- 4 anchor points LDV029 to avoid the pendulum effect.



01

Height Safety Systems
Horizontal and Inclined Fall Arrest

SecuRail® Horizontal and Inclined

- For 2 users
- Span of 3m to 5m with reinforcement
- Anodized Aluminium
- Absorbs dilatation and contraction of roof sheets
- Possibility of custom-made solutions with the Fallprotec's engineering department

EN795:2012 Type D
CEN/TS 16415:2013



→ The SecuRail is a rigid fall arrest rail that can be installed on ground, wall and ceiling configuration. Its rectangular shape integrates well in the aesthetics of buildings. The cross shaped junction absorbs the dilatation as a result of temperature variation.

A variety of 6 fall arrest trolleys make this rail highly versatile. The openable trolley VIA 6 enables the end user to connect and disconnect the trolley at any point of the rail.

The Multivia trolley or the VIA 4 trolley are recommended for sloped roofs.



Horizontal SecuRail lifeline on ground

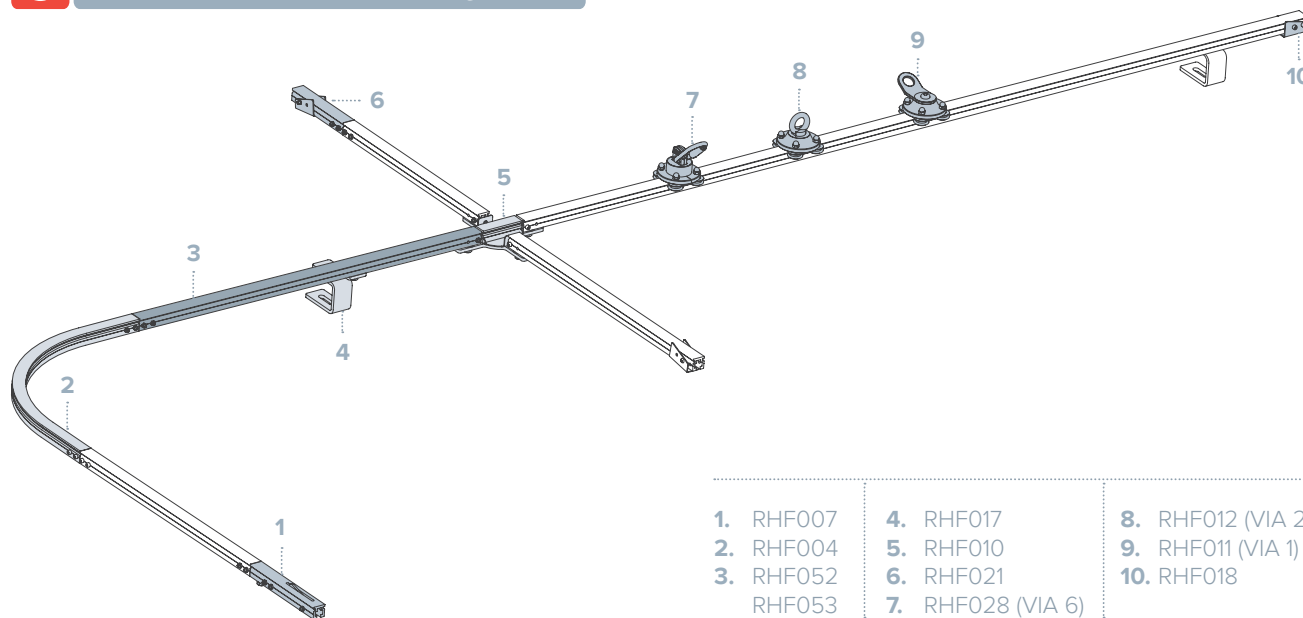

- | | | |
|---------------------|-------------------|-------------------|
| 1. RHF007 | 4. RHF017 | 8. RHF012 (VIA 2) |
| 2. RHF004 | 5. RHF010 | 9. RHF011 (VIA 1) |
| 3. RHF052
RHF053 | 6. RHF021 | 10. RHF018 |
| | 7. RHF028 (VIA 6) | |



SFU010 Anchoring device for standing seam roof

The SAFE U product range is specifically designed for common roofs such as tile, slate, cold deck and standing seam roofs. This system is designed to guarantee waterproofness. (Picture on the left)

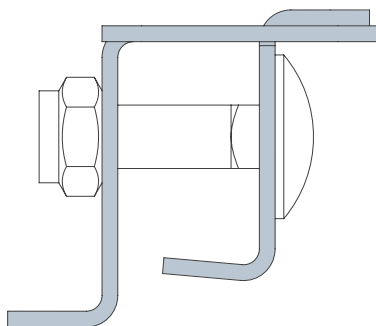

Trolley VIA 1

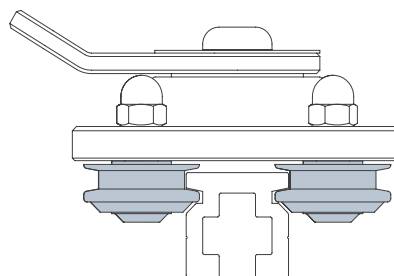

The rollers are in stainless steel with bushings to improve their movement along the rail.

Trolley VIA 5

Trolley for wall configuration. Different VIA trolleys are available depending on the system configuration.

RHF015

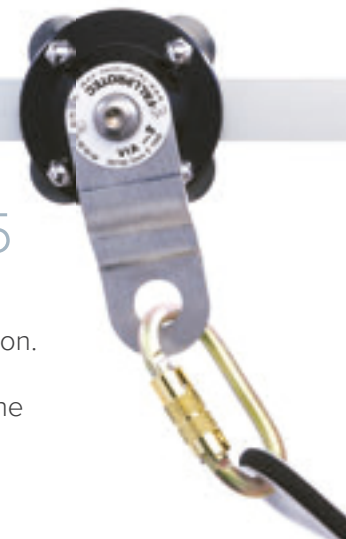

SecuRail® 2016

Horizontal

- For 2 users
- Span of 6 m
- Anodized aluminium
- Absorbs dilatation / contraction
- Possibility of custom-made solutions with the Fallprotec's engineering department

EN795:2012 Type D
CEN/TS 16415:2013



→ The SecuRail 2016 is a rigid and versatile fall arrest rail. This unique profile has a high inertia that enables a 6 meter span between supports.

It is ideal for work sites with low fall clearance.



Horizontal SecuRail 2016 lifeline on ground

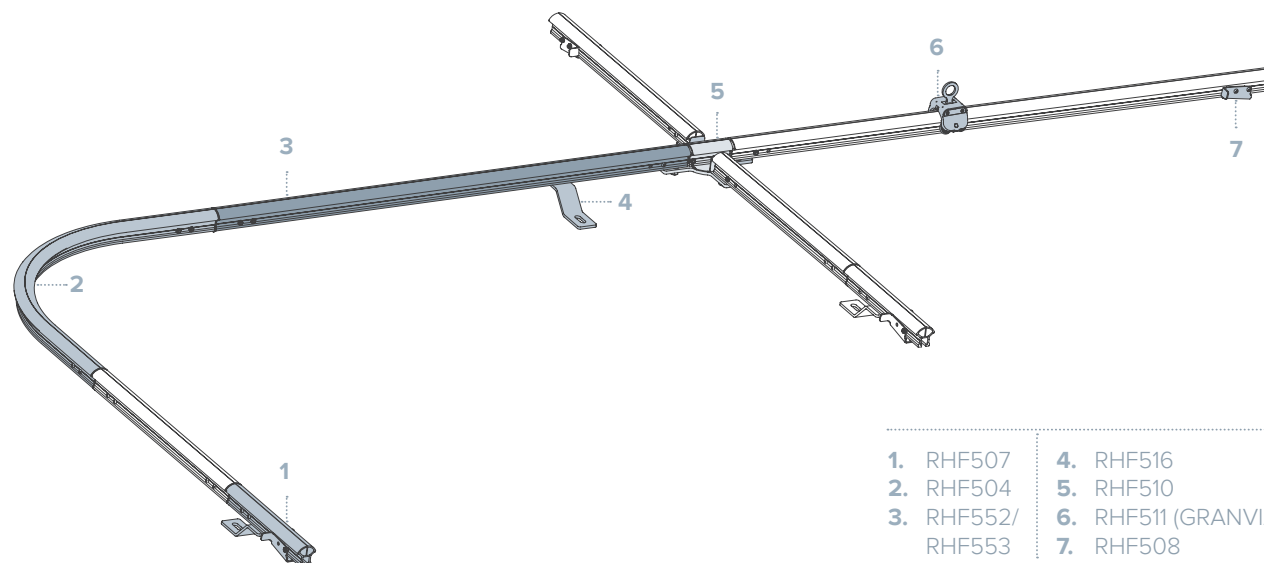

- | | |
|----------------------|---------------------|
| 1. RHF507 | 4. RHF516 |
| 2. RHF504 | 5. RHF510 |
| 3. RHF552/
RHF553 | 6. RHF511 (GRANVIA) |
| | 7. RHF508 |

Trolley GRANVIA

The GRANVIA fall arrest trolley equipped with rollers glides smoothly along the track following the user's movement. Anti-derailment claws mounted between the rollers keep the trolley firmly on the track. The same trolley is used for ground, wall and ceiling configuration.

RHF511 (GRANVIA)



Trolley GRANVIA

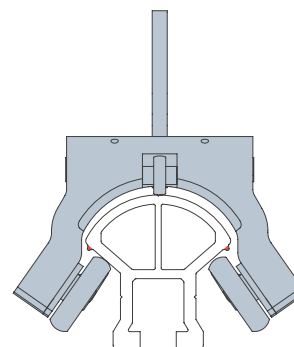

The rollers enable a smooth gliding of the trolley.



SFU002 Safety hook for tile roof

The Safe U product range can be used as safety hooks or it can be combined with the SecuRail 2016.

Walkways, steps and snow grids can also be mounted on SafeU to secure and facilitate access to sloped roofs. (Picture on the left)

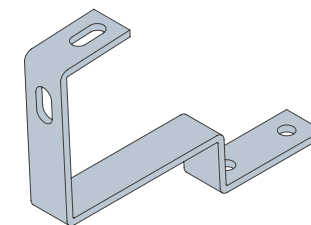



Rive Gauche Mall

Case Study

- Full system associating SafeLadder, SecuRail 2016 overhead fall arrest rail fixed on walkway and SecuRope over posts for building maintenance



📍 Belgium

The Brief

The Rive Gauche Mall is located in the heart of Charleroi and is part of a larger plan to develop the attractiveness of the city centre. Large glass facades bring a lot of natural light inside the building. They are equipped with walkways on each floor.

Fallprotec supplied a complete system to reach safely any point on the building. Fixed SafeLadders are integrated in

the sunshades to enable access to the walkway levels. SecuRail 2016 tracks are fixed on the underside of the walkway. The aluminium rail integrates perfectly with the aesthetics of the building and the trolley follows the user effortlessly.

On the surfaces, a network of SecuRope on posts allows the user to work on the roofs while remaining in safety at all times.





The Results

- 200m SecuRail 2016 overhead installed on 2 floors.
- 20m of SecuRope on posts.
- 40m of SafeLadders.
- Custom-made bendings of the rail.
- Design and calculation of the brackets.



SafeAccess® fall arrest

- For 4 users
- Span of 6m
- Undeformable
- ATEX certified
- Aluminium 6060T6
- Possibility of custom-made solutions with the Fallprotec's engineering department

EN795:2012 Type D
CEN/TS 16415:2013



→ The SafeAccess is an undeformable fall arrest rail for industrial applications. Installed in overhead configuration, it is the most suitable system when the fall clearance is low.

ATEX certified for potentially explosive atmospheres, this rail is also ideal for petrochemical industries.

The aluminium rail is protected by a high-quality powder coated surface treatment that resists to marine environment.

The NAV 2 trolley equipped with rollers follows smoothly without any action from the end user.



Horizontal SafeAccess fall arrest

Rail attached to two Flexbow structures equipped with energy shock absorbers.

The Flexbow base can be fixed directly to the ground or can be stabilized by counterweights.



- | | |
|-------------------|-----------|
| 1. MHS023 (NAV 2) | 5. MHS017 |
| 2. MHS059 | 6. FLX009 |
| 3. FLX005 | 7. FLX012 |
| 4. MHS061 | |



Trolley NAV 2

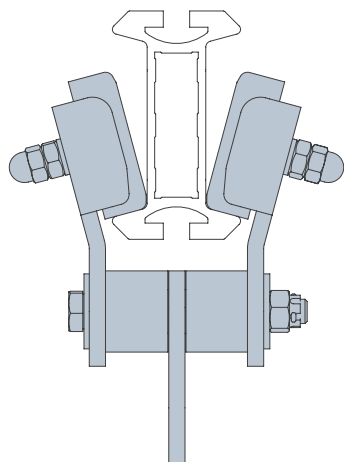

The SafeAccess rail combined with a safety block enables the safest possible fall arrest.

MHS023



SafeAccess rail

The SafeAccess received Atex certification for applications in potentially explosive atmosphere.

MHS059

01

Height Safety Systems
Vertical Fall Arrest

SecuRope®

- Cost-efficient solution
- Undeformable
- Freehand system
- Stainless steel elements



EN353-2:2014



→ SecuRope vertical assures a secured access thanks to the attachment to the glider, very close to the user for a short falling height. The glider equipped with energy absorber limits the force transmitted to the end user.

The SecuRope is a cost efficient solution for vertical safety. It can be mounted with EVO anchors, a competitive solution.

On demand, vertical SecuRope systems can be custom-made with the Fallprotec's engineering department.



SecuRope Vertical lifeline

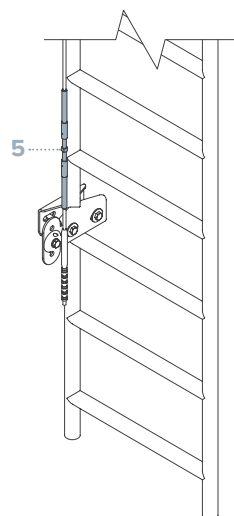
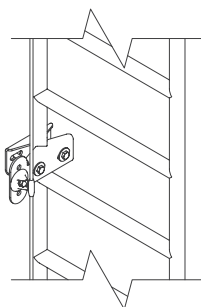
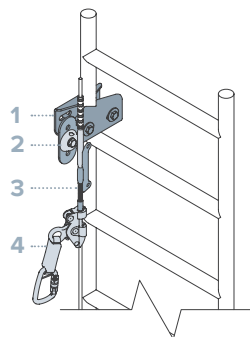

Ladder lifeline

1. NSV006
2. LDV106 (TEVO)
3. LDV107
4. NSV009
5. LDV038

ZIP! fall arrest glider fitted with energy absorber

Passing smoothly through the anchors, the glider locks in case of a fall.

NSV009

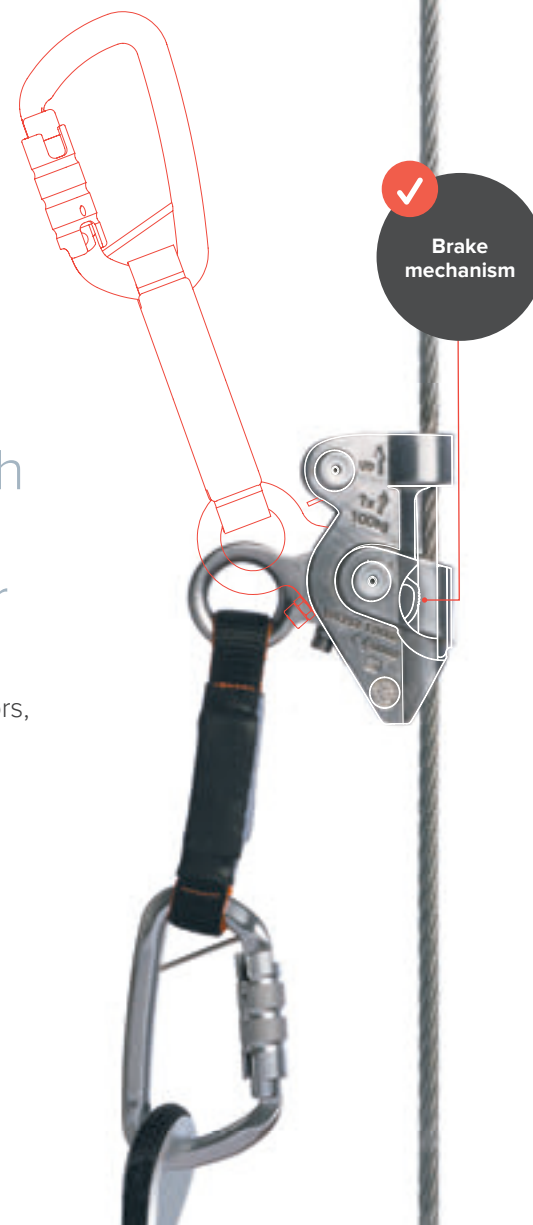

01

Height Safety Systems
Vertical Fall Arrest

SecuRail®

- Ergonomic
- Energy absorber integrated in the trolley
- Rigid rail
- Fixed or foldable rungs available
- Possibility of custom-made solutions by the Fallprotec's engineering department



EN353-2:2014



→ The SecuRail Vertical is a rigid lifeline to secure access on any structure. When clamped on an existing ladder it secures the end user much better than the regular safety hoops.

SecuRail Vertical fitted with fixed rungs is designed for confined spaces, for industrial halls or for telecommunication towers. Undeformable stainless steel brackets connect the SecuRail ladder to the structure.

SecuRail Vertical equipped with foldable rungs is a discreet system for architectural or residential buildings. When the ladder is not used, the rungs are folded on the rail to minimize the visual impact. Undeformable stainless steel brackets connect the SecuRail ladder to the structure.



SecuRail ladder with foldable rungs and SecuRail 2016 lifeline clamped on a ladder

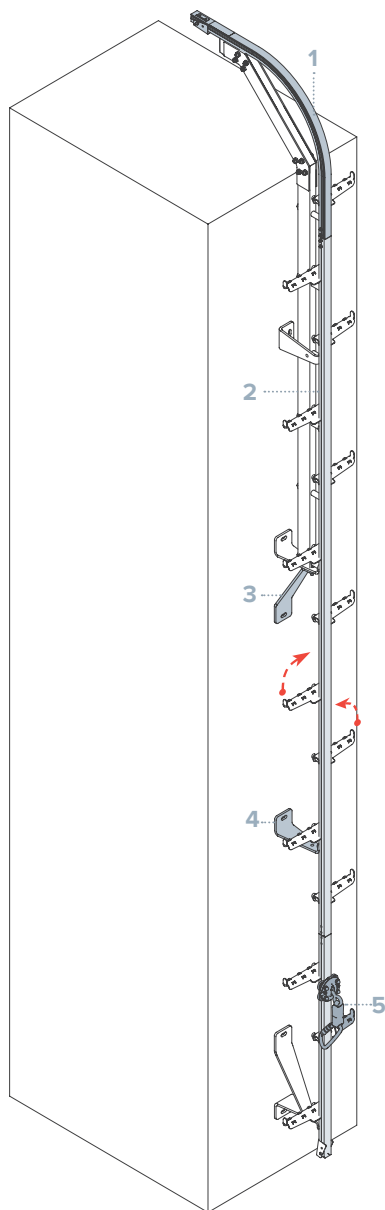

Ladder lifeline

1. RHF049
2. RHF030
3. RHF061
4. RHF060
5. RHF014 (VIA 4)

The SecuRail vertical 2016

1. RHF507
2. RHF518 (VIA 4)
3. RHF552
RHF553
4. RHF521
5. RHF520

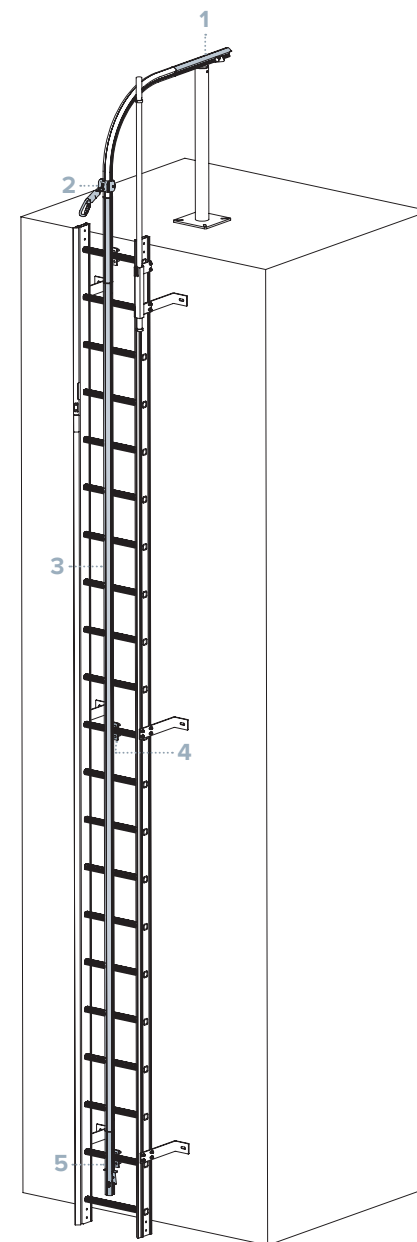

SafeLadder®

- Intuitive use
- Integrated rigid fall arrest
- Rigid and stable ladder
- Standard brackets in various lengths
- Anodized aluminium
- Possibility of custom-made solutions with the Fallprotec's engineering department



EN353-2:2014



→ The SafeLadder is a more elegant and secure alternative to traditional cage ladders. The end user, equipped with a harness, is directly connected to the fall arrest rail which is integrated in the ladder upright.

The VIA 4 trolley equipped with energy absorber follows the user effortlessly and locks instantly in case of a fall. Many accessories are available for a great versatility of configurations.



Platform over parapet

The platform allows to secure roof access in compliance with EN353-2.

SAL026

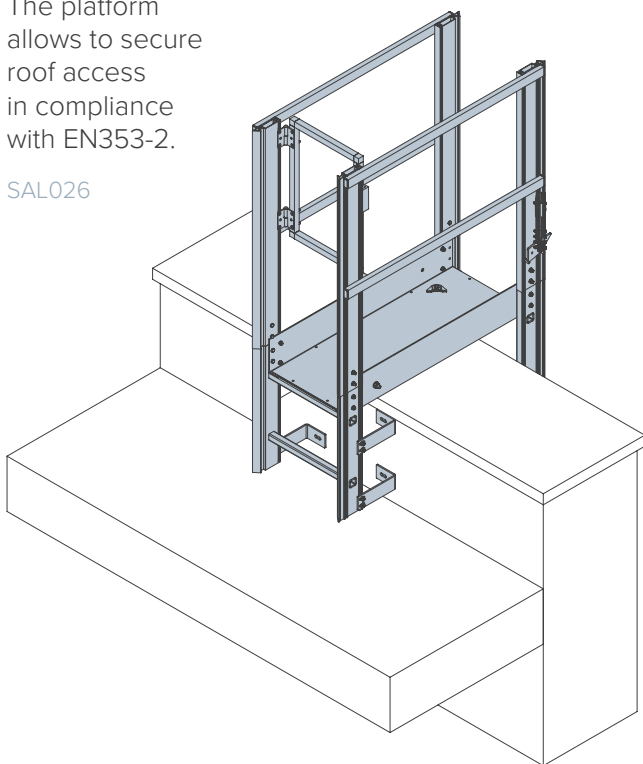

SafeLadder

Ladder equipped with a fall arrest system.

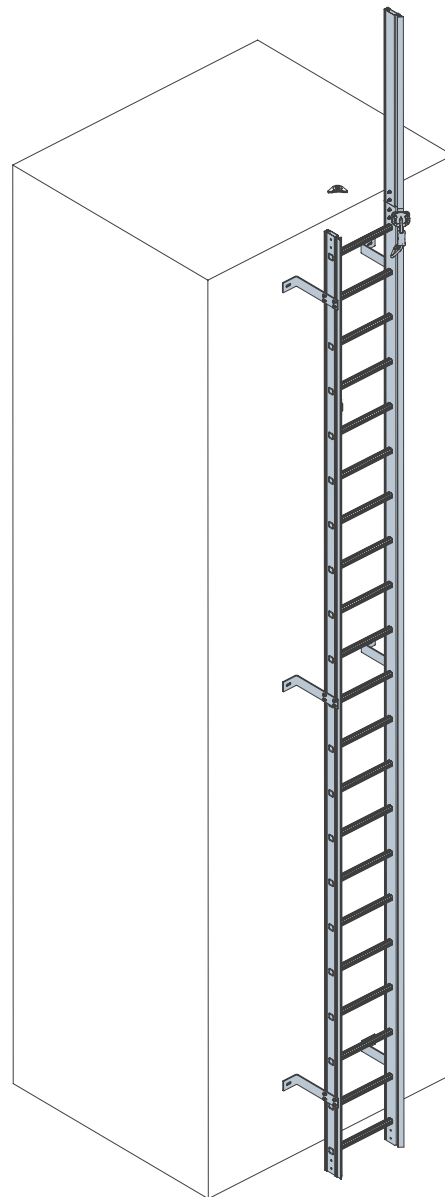

Temporary installed ladder

A discreet installation for walls with a maximum height of 5m.

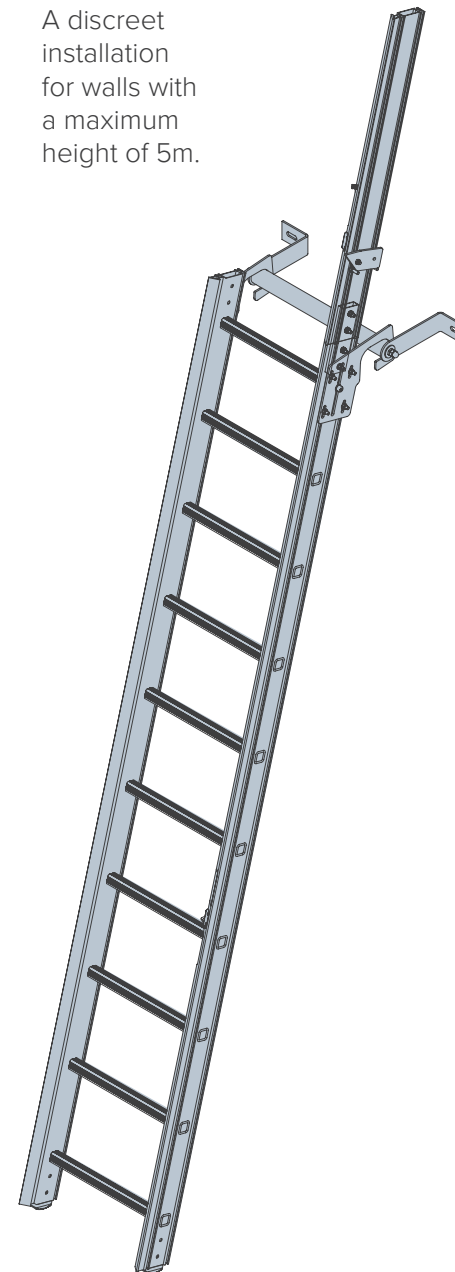

SafeLadder®

- Intuitive use
- Integrated rigid fall arrest
- Rigid and stable ladder
- Standard brackets in various lengths
- Anodized aluminium
- Possibility of custom-made solutions with the Fallprotec's engineering department



EN353-2:2014





SafeLadder with traversing trolley on SafeAccess rail

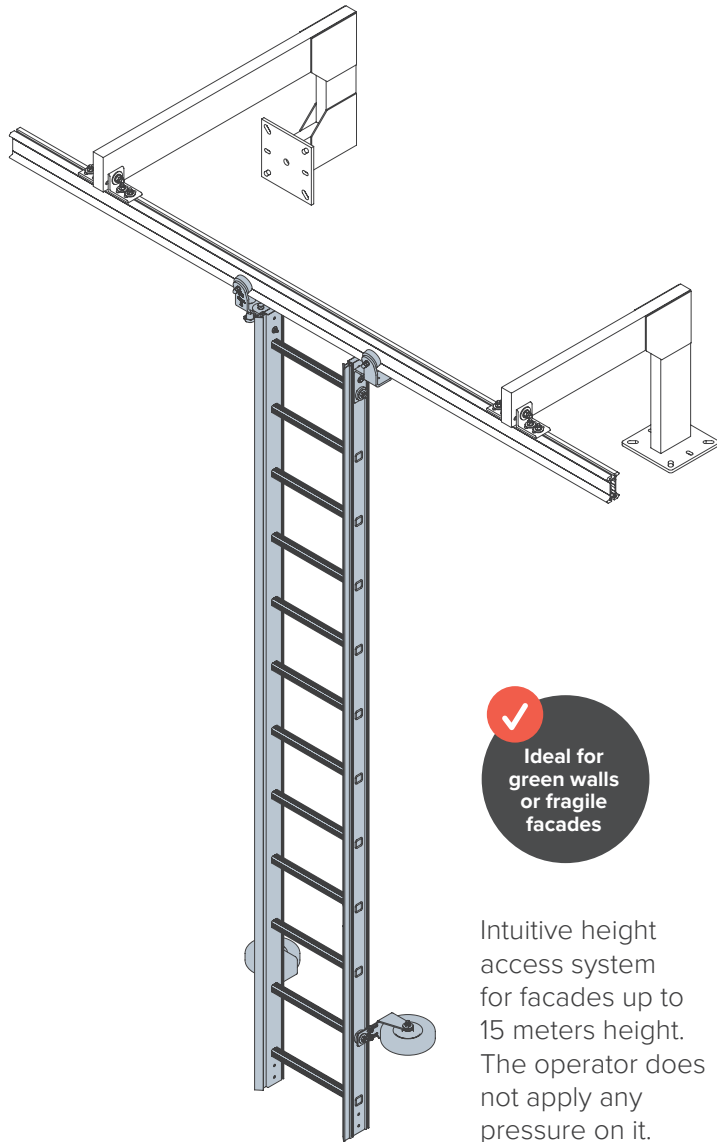

✓
Ideal for
green walls
or fragile
facades

Intuitive height
access system
for facades up to
15 meters height.
The operator does
not apply any
pressure on it.



Telescopic SafeLadder

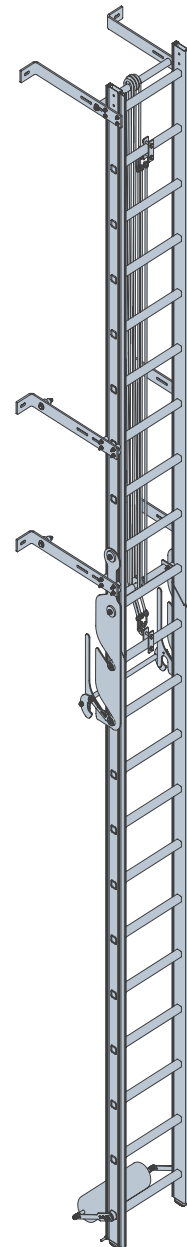

It prevents
unauthorized
access
and remains
discreet when
not in use.

SAL028



SafeLadder for confined spaces

The fold up section is designed for wells or other confined space where the access is made from the top. The operator can safely open the hatch as the ladder obstructs the hole. By simply pulling a sling the ladder unfolds and arises 110cm above floor level to facilitate the access.

SAL023

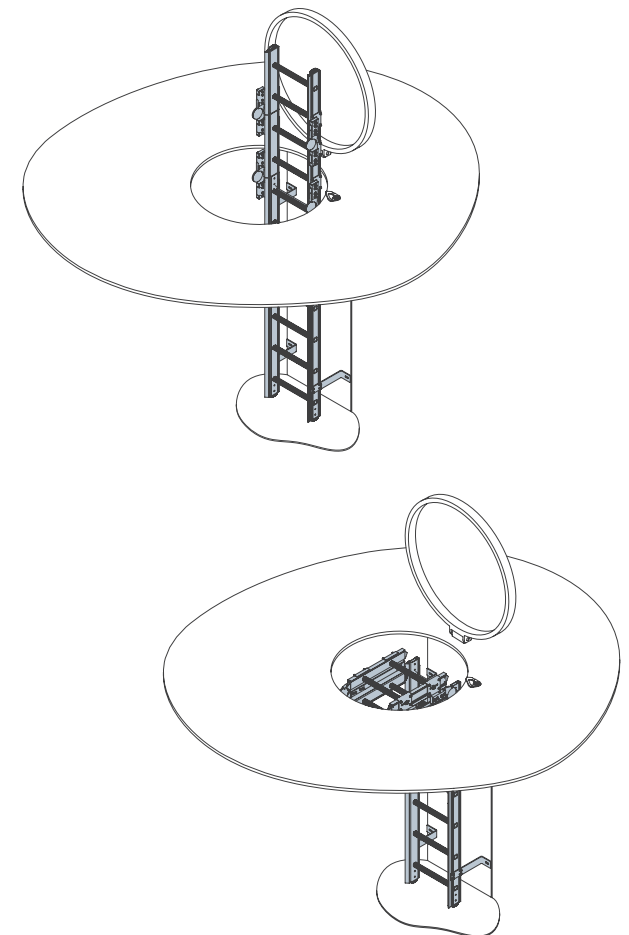

Anchor Points

- Anchor points for every application
- 1 or 2 users depending of model
- Undeformable
- Compatible with Fallprotec fixing brackets
- Stainless steel
- Possibility of custom-made solutions with the Fallprotec's engineering department

EN795:2012 Type A
CEN/TS 16415:2013



SafeAnchor

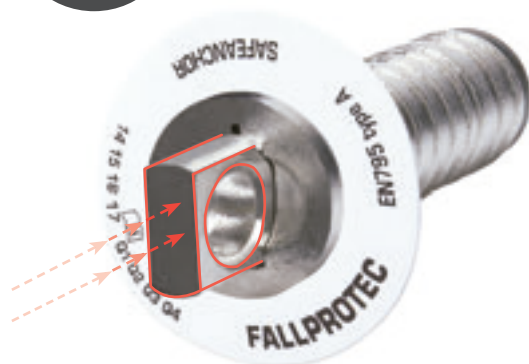

SafeAnchor is a spring loaded and discreet anchoring point to be fitted in aesthetic facilities.

The SafeAnchor is embedded in concrete and the anchoring eye appears by a simple pressure on the device.

Can be installed on wall or ceiling configuration.

Neat system to secure openable windows.

LDV055

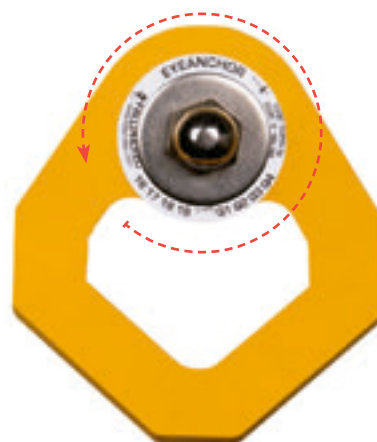

Rotating high visibility anchor point

Yellow anchor point for 2 users is in stainless steel and powder coated to increase visibility.

Fixed by one M12 bolt the anchor point is rotative to follow the end user. It can be installed on ground, wall or ceiling configuration.

With a breaking strength above 35kN, it can also be combined with temporary textile lifelines.

LDV029

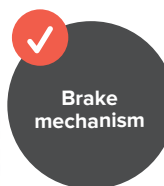

Anchor point with energy absorbing device for one person.

Specially designed to reduce forces transmitted to fragile structures, this anchor point is ideal for metal roofs.

Can be installed on ground, wall or ceiling configuration.

LDV025

Anchor Points

- Anchor points for every application
- 1 or 2 users depending of model
- Undeformable
- Compatible with Fallprotec fixing brackets
- Stainless steel
- Possibility of custom-made solutions with the Fallprotec's engineering department

EN795:2012 Type A
CEN/TS 16415:2013



Twinfix anchor point for 1 user

With a breaking strength above 25kN it can stop a fall without any permanent deformation. Reliable model for suspended rope access.

Can be installed on ground, wall or ceiling configuration.

LDV057



Twinfix anchor point for 2 users

With a breaking strength above 50kN it can stop a fall without any permanent deformation.

Reliable model for suspended rope access. The large opening of the anchor point facilitates the connection of big carabiners. Can be installed on ground, wall or ceiling configuration.

On concrete or slab, the anchor point can be fixed with two independent bolts. On a metallic structure, it can be fixed with one central bolt.

PTA016



SpotAnchor

SpotAnchor is installed on hot deck roofs to secure specific areas such as access zones, building corners or smaller roofs.

The high resistance toggle bolt ensures long-lasting fixing to the corrugated metal sheet and minimises eventual thermal bridges.

The roofing collar, in bitumen or PVC-P, is pre-fitted in the factory to guarantee the waterproofness.

The rotating anchor point permits to follow the progress of the end user.

LDV052



01

Height Safety Systems
Personal Protective Equipment

Harnesses and Lanyards

- Easy and quick to put on
- Two type "A" anchoring points
- Made in EU

CE

EN362:2005 / EN358:2003
EN361:2003 / EN355:2003
EN365:2005 / EN813:2009



Multifunctional full body harness and single elastic lanyard with energy absorber

5 anchor points, suited for rope access and rescue, it is the typical companion of many industrial climbers and service technicians. The single elastic lanyard of 2m with energy absorber connects safely the user to any Fallprotec fall arrest system. The integrated energy absorber reduces the forces transmitted to the user to max. 6kN. Since it is elastic, the lanyard adapts to the movements of the user, let him/her evolve freely along the lifeline or in the vicinity of an anchor point.

HAR067 / HAR010



Elastic 2 points harness and double elastic lanyard with energy absorber

A harness that adapts to the body movements, with automatic buckles. The double elastic lanyard with energy absorbers enables the user to pass from one anchoring point to another while remaining connected at all times.

HAR073 / HAR016



Prolight Harness

The emblematic harness of Fallprotec is lightweight and equipped with pads for the highest level of comfort. The operator can work all day without feeling any pressure point.

HAR002



Tempo Harness

A classic harness with webbing. Ideal for punctual operations where fall prevention is needed.

HAR021



Retractable blocks

- Energy absorbing
- Made in EU



EN354:2011 / EN355:2003
EN360:2003 / EN362:2005



→ These sturdy blocks are certified for ceiling, wall and ground configuration. The overspeed system stops a fall in a very short distance. The integrated energy absorption mechanism ensures that the maximal force transmitted to the end user is 6kN.

The ultra-compact block is a user-friendly device. In areas with limited fall clearance the retractable is installed in overhead configuration. When installed on the ground it also enables the user to reach areas further away from the Fallprotec lifeline.

Working seat, automatic braking descender and secondary fall arrest device

This assembly enables a safe and comfortable work at height for rope access specialists.

The harness and seat are ergonomic, maintaining the position of the user without soliciting the muscles. The harness follows the movements of the user, giving him/her more freedom. The fall arrest equipped with an energy absorber blocks automatically in case of a fall. The descender gives full freedom of movement in the vertical axis.

HAR014, HAR023 / HAR095



Ultra-compact blocks

Complete range of retractable fall arresters from 2 to 60 meters. Available with webbing strap or galvanised steel cable. The spring mechanism keeps a constant tension on the lanyard, thus facilitating the movement of the end user.

IHWB2 / IHWS9



Fall Arrest

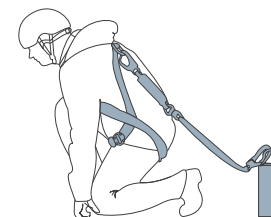

Fall Restraint

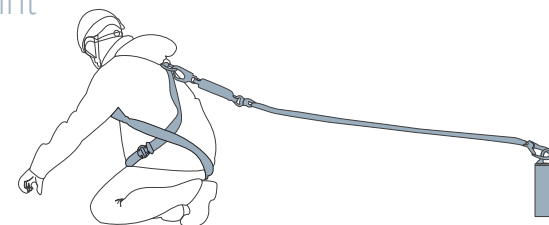

Fall restraint system prevents a person from reaching the fall risk and a fall arrest system minimises injury in the event of a fall.

01

Height Safety Systems and Safe Access equipment

Horizontal and Vertical Fall Arrest, SafeAccess



KAPSARC

Case Study

- Completely tailor-made project
- More than 6500m of lifelines
- Walkways, platforms and stairs for variable slopes
- 5 different buildings



📍 Saudi Arabia

The Brief

A wide range of bespoke solutions and fixing assemblies are set up on KAPSARC Research Center.

As specialist, we offer the complete solution, from site auditing and risk analysis to installation, commissioning and training.



Stress measured on platforms

Units: MPa

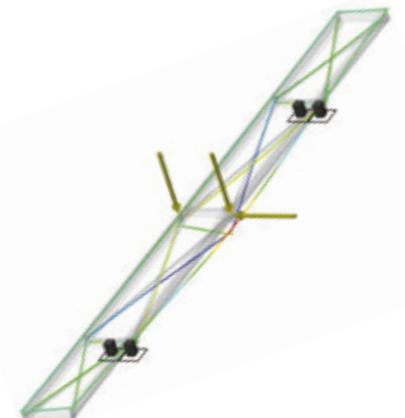
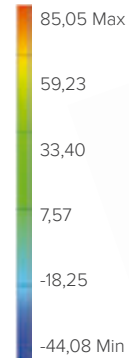



Stress measured on posts

Units: MPa

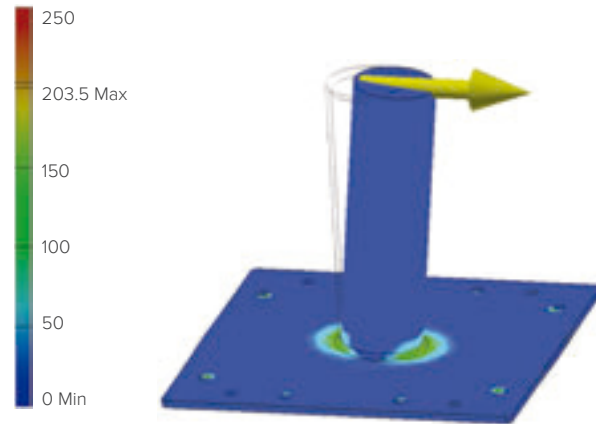

The Results

- 12 complex rail tracks for courtyards access, up to 63°.
- 600m of Climbing SafeAccess.
- 100m of platforms and walkways.
- 300m of stairs.
- Over 1500 posts (fixed on standing seam roof) for lifelines, stairs and abseiling points.



SafeAccess®

- Discreet system which underlines the shape of the building
- Compatible with traversing ladders, rope access technicians, RopeClimber and suspended platforms
- Powder coated
- Possibility of custom-made solutions with the Fallprotec's engineering department

EN1808:2015



→ The SafeAccess for suspension work is an efficient height access system for facade maintenance and cleaning.

Highly versatile, it can be installed in building entrances, atriums, courtyards and on the building main facades. Suspended access on structures of 5 to 300m height.

The track can be curved and powder coated in any RAL colour.

The trolleys roll on the flange of the rail. Manually, motorized or battery operated trolleys are used for horizontal movements.

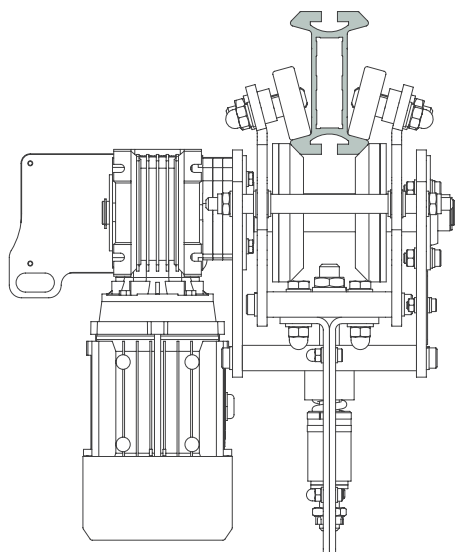
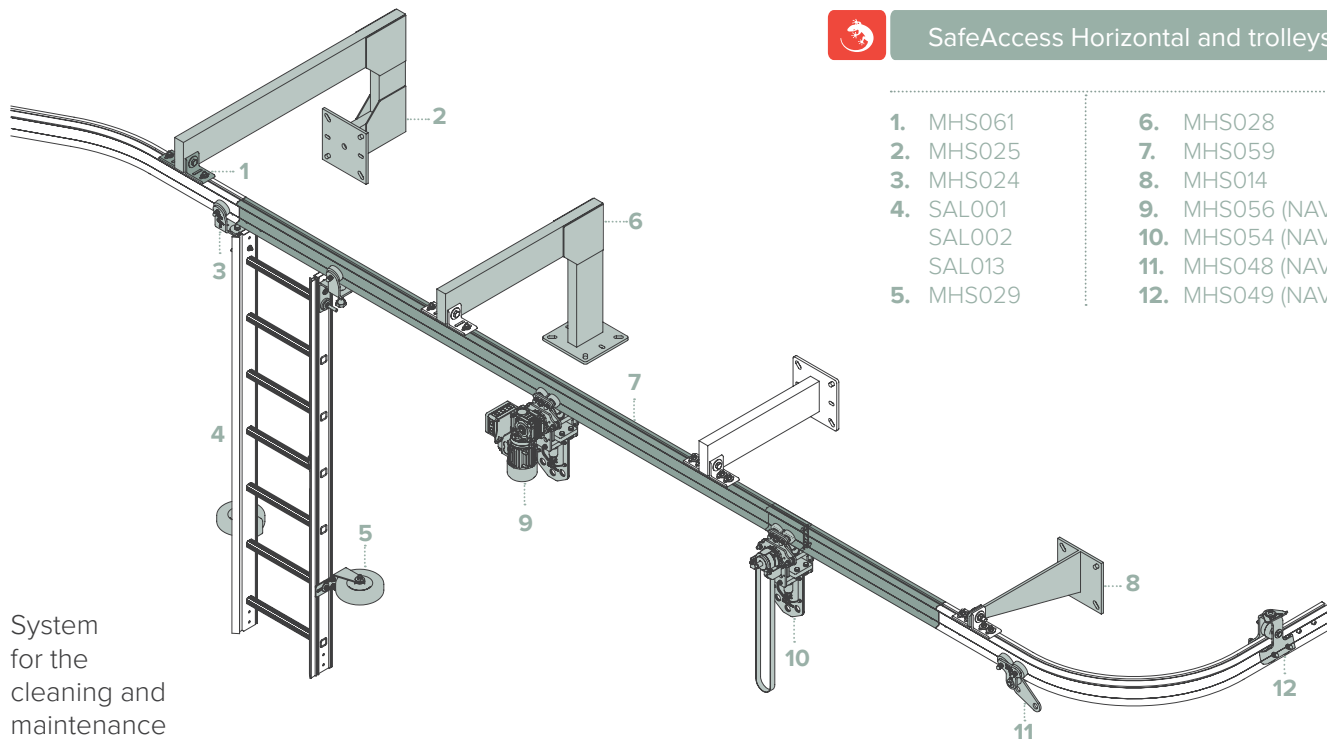

Trolley NAV 4

Motorised trolley for the suspension of cradles and RopeClimber lifting machine. The trolley is controlled from the suspended equipment.

MHS056



NAV 1 Trolley manually operated by drive belt.

Compatible with the RopeClimber.

MHS054



New Antofagasta Hospital

Case Study

- Completely tailor-made project
- Securing the cleaning and maintenance of 2 different buildings facades
- Securing the cleaning and maintenance of 13 courtyards
- Requirements with very high standards by local regulations



Chile

The Brief

Two Building Maintenance Units were the fastest and easiest way to clean all the external facades. To maintain internal courtyards, 20 sections of SafeAccess monorail have been installed for the suspension of the RopeClimber.

The hoist does not require a big storage area and is powered by battery. It is easy to transport between the courtyards and it can access remote facade areas. Engineering calculations for both systems have been thoroughly evaluated and approved by SIRVE Institute - Seismic Protection Technologies. The BMUs have been designed and produced by FBA Gomyl.



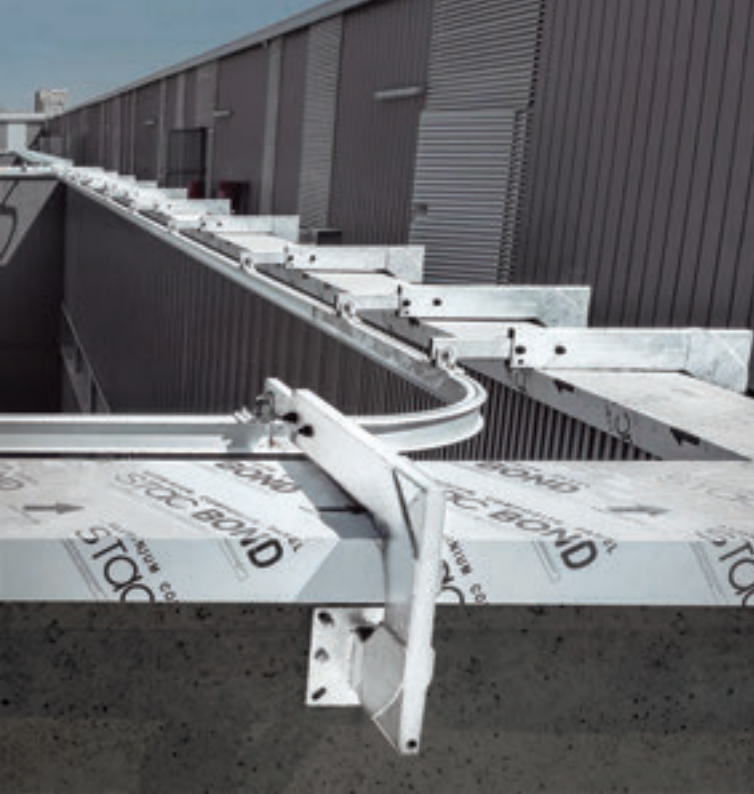

The Results

- 780m of SafeAccess rail for the maintenance of the courtyards.
- 2 RopeClimber suspended from SafeAccess rail.
- 2 Building Maintenance Units.
- 650m of rail attached to the inner parapet for the BMUs.



02

Safe Access Equipment
Works In Suspension

SafeAccess®

Type C

- Compatible with rope access technician, RopeClimber and suspended platforms
- Aluminium mill finished or powder coated on demand
- Possibility of custom-made solutions with the Fallprotec's engineering department

EN1808:2015



→ The SafeAccess C is a discreet access system that is concealed in a technical ceiling or a soffit. The rail integrates harmoniously the aesthetics of the building. The track can be curved and powder coated in any RAL colour. Custom-made brackets enable to align the rail and the ceiling. The trolleys roll in the inner channel of the rail.

Manually, motorized or battery operated trolleys are used for horizontal movements. Compatible with rope access technicians, the RopeClimber and suspended platforms.



SafeAccess C Horizontal / Inclined and trolleys

- | | |
|---------------------|-----------|
| 1. MHS500 | 5. MHS511 |
| 2. MHS506 (PILOT 2) | 6. MHS504 |
| 3. MHS509 (PILOT 4) | 7. MHS501 |
| 4. MHS503 (PILOT 1) | |

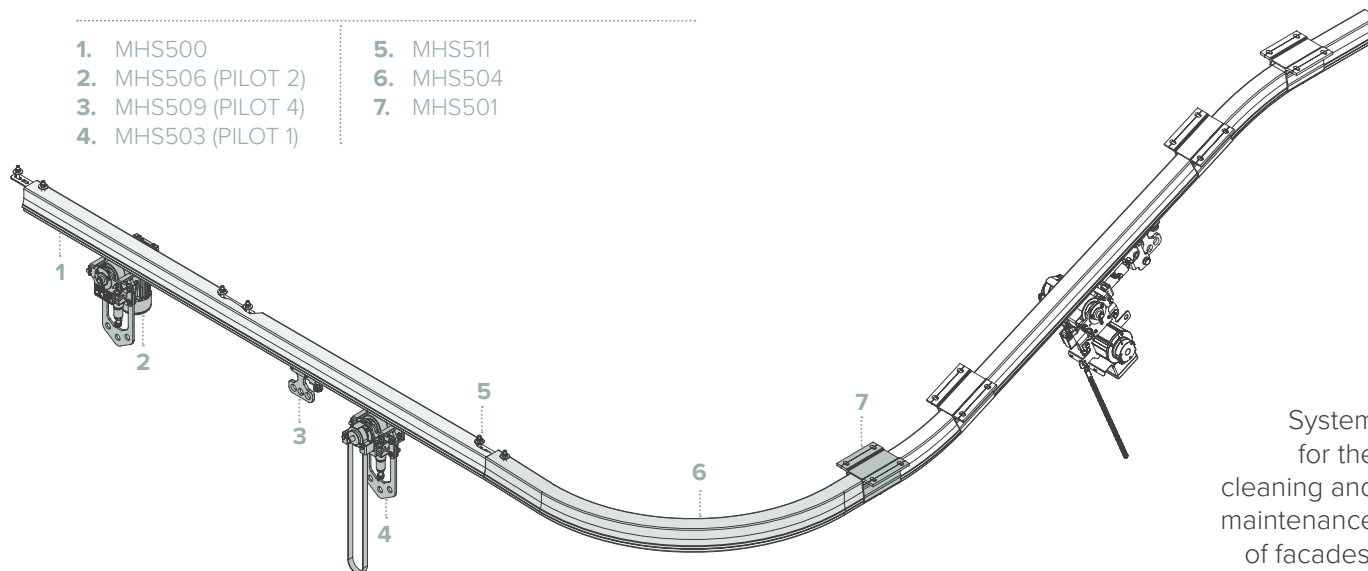

System for the cleaning and maintenance of facades.



Pilot 2 attached to SafeAccess C rail profile

Motorised trolley for the suspension of cradles and RopeClimber lifting machine.



Controlled from the suspended equipment

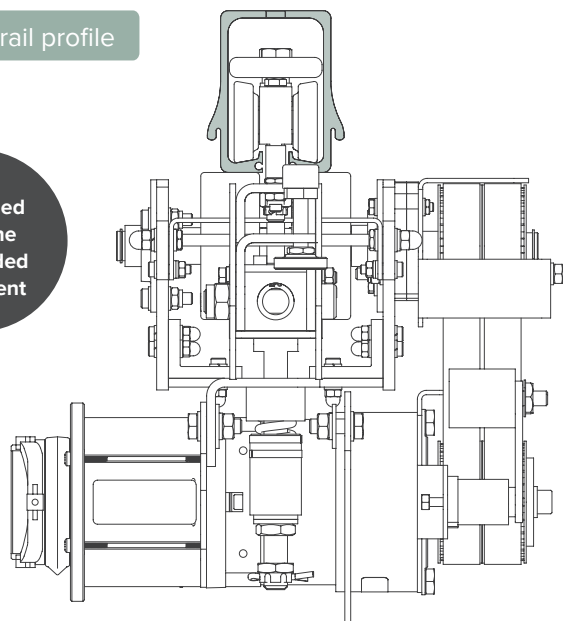

Pilot 1 Trolley manually operated by drive belt

Compatible with the RopeClimber.

MHS503

SafeAccess® Climbing

- Active drive system
- Slopes up to 70°
- Span of 3m between supports
- Compatible with rope access technician, RopeClimber and cradles
- Bespoke solutions by Fallprotec engineering department

EN1808:2015



→ The Climbing SafeAccess is installed on sloped facades or atriums for the maintenance and cleaning of the building. A high resistance stainless steel chain is inserted through the bottom channel of the rail.

The climbing trolley with pinion can climb slopes up to 70°. A chain based design is the most reliable system for installations with an important slope.



Trolley NAV 6

The trolley equipped with 2 independent electric engines for the highest level of safety.

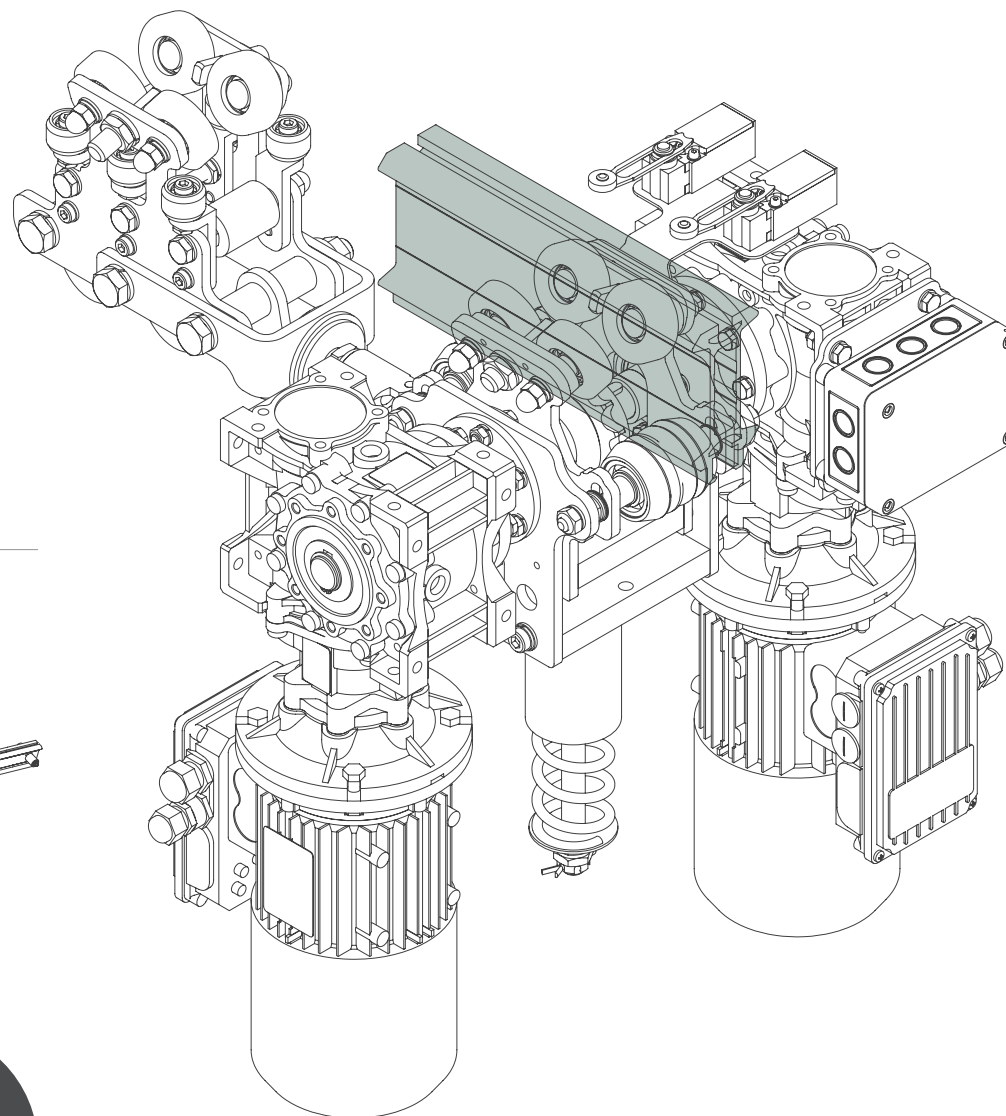

Climbing SafeAccess and trolleys

1. MHS065
2. MHS047
3. MHS040

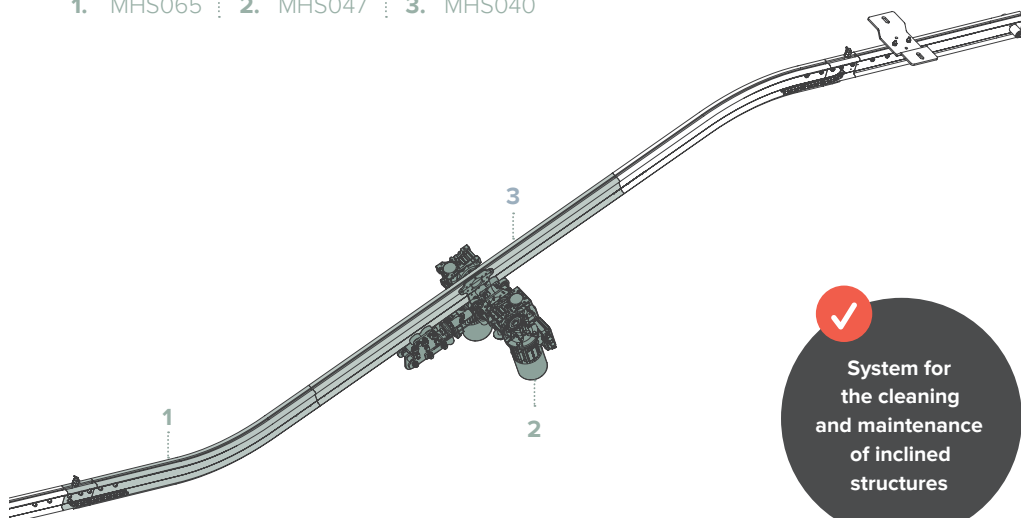

System for the cleaning and maintenance of inclined structures

RopeClimber Lifting Equipment

- Working Load up to 240kg and lifting speed up to 11,5m/min
- Autonomy up to 8 hours depending on use
- Usable by anyone with half-day training

EN 1808:2015 / EN60204-1
Directive 2006 / 42 / EC





→ RopeClimber Backpack

(picture on the left)

ROP021



**Combinable
with SafeAccess
suspension rail or
davit system**

- Safety features: fall arrest device on the secondary rope, overload and top limit switch
- Push buttons control box with emergency stop
- Intuitive use, training as professional climber is not required
- LED that informs about the state of charge of the battery as well as safety features
- Equipped with wheels for easy transport.
- Versatile equipment
- Cost-efficient solution
- Battery powered
- Lightweight and compact
- Optimized time of installation
- Ergonomic and comfortable for people working at height
- All accessories are according to EN1808:2015



Tianjin International Convention Center

Case Study

- Fully autonomous and light battery powered system to access facades
- RopeClimber cradle, climbing trolley and SafeAccess C rail

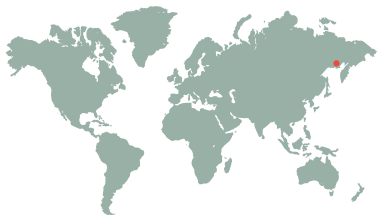

China

The Brief

The International Convention Centre in Tianjin is a unique building shaped by slopes and curves. Its facade is going inward at every floor. Located in the heart of the Tianjin Financial Centre, it is home to a five-stars hotel, a convention centre and several major financial corporations.

Fallprotec designed and supplied a lightweight battery powered height access system. A climbing SafeAccess C rail is integrated in the building's canopy and merges into the architecture of the building. High friction trolleys powered by battery roll along the track. The RopeClimber cradle can reach any point of the concave facade thanks to restraint systems.





The Results

- 600m of SafeAccess C rail.
- Battery powered climbing trolley.
- RopeClimber cradle carrying up to 2 people.
- Sloped sections up to 15°.
- Inward facade fitted with restraint systems for work positioning.



Luxembourg
FALLPROTEC SA

43-45, ZA Op Zaemer
4959 Bascharage
T: +352 26 55 09 30
F: +352 26 55 09 30 55
E: marketing@fallprotec.com

Spain
FALLPROTEC SL

C/ Eduard Calvet i Pintó 4
Pol. Ind. Vallmorena
08339 Vilassar de Dalt
T: +34 93 114 22 31
E: info@fallprotec.es

Chile
FALLPROTEC LATAM

Avda. Alcalde Carlos Valdovinos 2199
Santiago de Chile
Región Metropolitana
T: +56 2 2512 6133
E: latam@fallprotec.com



www.fallprotec.com

